



High Performance Cutting Tools



**CARBON STEEL TAPS &
ROUND & HEXAGONAL DIES**

ICON GALLERY

TOOL MATERIAL

CS High Carbon Steel

HSS High Speed Steel M2 Grade

STANDARD

ANSI
94.9 ANSI 94.9

BS
949 BS949:1951

BS
1127 BS1127: 1974

DIN
22568 DIN 22568

CLASS OF THREAD

2A 2A

2B 2B

6G 6G

ZONE
5 ZONE 5

CHAMFER

T/B Set of Taper & Bottom Hand Tap

T/S/B Set of Taper, Second & Bottom Hand Tap



High Performance Cutting Tools



CARBON STEEL HAND TAPS

CONTENTS



CARBON STEEL HAND TAPS

THREAD FORM	BLANK STANDARD	TOLERANCE	CHAMFER	PAGE
M	BS 949	Zone 5	T/S/B	5.003
MF	BS 949	Zone 5	T/S/B	5.005
BSW	BS 949	Zone 5	T/S/B	5.007
BSF	BS 949	Zone 5	T/S/B	5.009
BA	BS 949	Zone 5	T/S/B	5.010
BSB	BS 949	Zone 5	T/S/B	5.011
BS Con	BS 949	Zone 5	T/B	5.012
ME	BS 949	Zone 5	T/S/B	5.013
BS Cy	BS 949	Zone 5	T/S/B	5.014
WF	BS 949	Zone 5	T/S/B	5.015
BSP	BS 949	Zone 5	T/B	5.016
BSPT	BS 949	Zone 5	T/B	5.017
UNC	ANSI 94.9	2B	T/S/B	5.018
UNF	ANSI 94.9	2B	T/S/B	5.019
NPT	ANSI 94.9	2B	T/B	5.021
NPS	ANSI 94.9	2B	T/B	5.022
UNS	ANSI 94.9	2B	T/S/B	5.023



M

Metric coarse threads

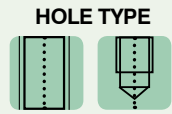
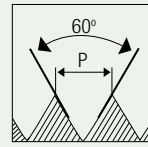

CS

BS 949

ZONE 5

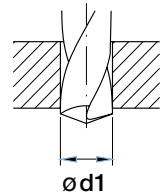
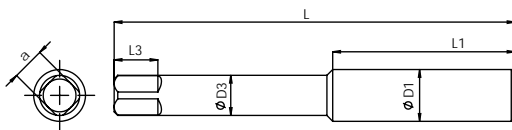

								Unit : mm
Nominal Diameter	Pitch	EDP No.	Overall Length	Thread Length	Shank Diameter	Square Size	Square Length	Tapping Drill Diameter
ØD1	p		L	L1	ØD3	a	L3	Ød1
M 2	0.4	FBA0204977	44.03	11.5	3.25	2.58	4.46	1.6
M 2.2	0.45	FBA0205005	45.72	15	3.25	2.58	4.46	1.75
M 2.5	0.45	FBA0205061	47.51	15	3.25	2.58	4.46	2.05
M 3	0.5	FBA0205117	49.4	17	3.25	2.58	4.46	2.5
M 3.5	0.6	FBA0205174	52.85	20.6	3.66	2.86	4.46	2.9
M 4	0.7	FBA0205231	56.33	22.5	4.22	3.26	6.05	3.3
M 4.5	0.75	FBA0205318	62.99	26.6	4.8	3.69	6.05	3.7
M 5	0.8	FBA0205404	63.29	26.6	5.41	4.15	6.05	4.2
M 6	1	FBA0205632	67.04	30.7	6.15	4.71	6.84	5
M 7	1	FBA0205716	67.68	30.7	7.21	5.5	7.64	6
M 8	1.25	FBA0205831	69.85	30.5	8.2	6.23	8.43	6.8
M 9	1.25	FBA0205943	74.61	33.7	9.12	6.9	10.02	7.8
M 10	1.5	FBA0206091	74.61	33.7	10.29	7.73	10.02	8.5
M 11	1.5	FBA0206204	80.17	36.5	8.2	6.06	10.02	9.5
M 12	1.5	FBA0206324	85.83	42.1	9.32	6.9	10.81	10.5
M 12	1.75	FBA0206356	85.83	42.1	9.32	6.9	10.81	10.2
M 14	1.5	FBA0206529	91.28	42	10.91	8.07	12.4	12.5
M 14	2	FBA0206560	91.28	42	10.91	8.07	12.4	12

CS TAPS



M Metric coarse threads

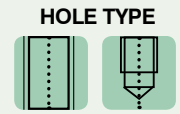
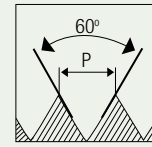

CS
BS 949
ZONE 5
T/S/B

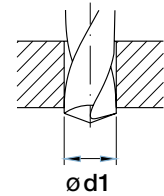
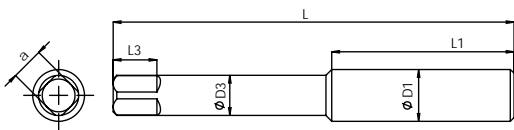

CS TAPS

								Unit : mm
Nominal Diameter	Pitch	EDP No.	Overall Length	Thread Length	Shank Diameter	Square Size	Square Length	Tapping Drill Diameter
ØD1	p		L	L1	ØD3	a	L3	Ø d1
M 16	2	FBA0206759	96.84	46	12.2	9.04	13.99	14
M 18	2.5	FBA0206986	102.4	46	13.78	10.2	15.58	15.5
M 20	2.5	FBA0207100	107.95	50.8	15	11.12	17.16	17.5
M 22	2.5	FBA0207215	119.06	56.4	17.71	13.17	18.75	19.5
M 24	3	FBA0207359	124.62	56.35	19.31	14.37	18.75	21
M 27	3	FBA0207559	129.8	63.5	20.35	15.13	20.2	24
M 30	3.5	FBA0207815	137.8	65	22.79	16.96	21.9	26.5
M 33	3.5	FBA0208015	145.8	65	25.98	19.34	25.2	29.5
M 36	4	FBA0208155	153.8	76	28.17	20.99	26.7	32
M 39	4	FBA0208211	161.8	76	31.35	23.38	28.2	35
M 42	4.5	FBA0208295	169.8	81	33.18	24.75	28.2	37.5
M 45	4.5	FBA0208323	177.8	81	36.35	27.12	31.7	40.5
M 48	5	FBA0208351	185.3	90.5	38.61	28.82	31.7	43
M 52	5	FBA0208407	193.3	90.5	38.61	28.82	31.7	47



MF

Metric fine threads

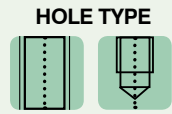
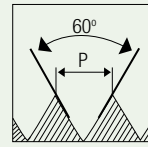

CS

BS 949

ZONE 5

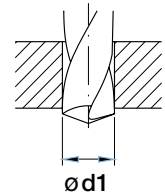
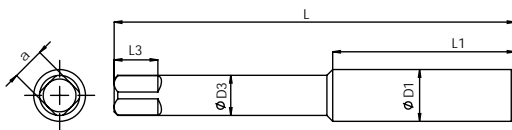

								Unit : mm
Nominal Diameter	Pitch	EDP No.	Overall Length	Thread Length	Shank Diameter	Square Size	Square Length	Tapping Drill Diameter
ØD1	p		L	L1	ØD3	a	L3	Ø d1
M 2.3	0.4	FBA0205033	45.81	15.00	3.25	2.58	4.46	1.9
M 2.6	0.45	FBA0205089	49.16	17.00	3.25	2.58	4.46	2.1
M 3	0.6	FBA0205146	49.36	17.00	3.25	2.58	4.46	2.4
M 4	0.5	FBA0205202	56.33	22.50	4.22	3.26	6.05	3.5
M 4	0.75	FBA0205259	56.33	22.50	4.22	3.26	6.05	3.25
M 5	0.5	FBA0205346	63.29	26.60	5.41	4.15	6.05	4.5
M 5	0.9	FBA0205432	63.29	26.60	5.41	4.15	6.05	4.1
M 5.5	0.9	FBA0205517	63.58	26.60	5.61	4.30	6.05	4.6
M 6	0.75	FBA0205573	67.13	30.70	6.15	4.71	6.84	5.2
M 8	0.75	FBA0205772	69.85	30.50	8.20	6.23	8.43	7.2
M 8	1	FBA0205800	69.85	30.50	8.20	6.23	8.43	7
M 9	1	FBA0205915	74.61	33.70	9.12	6.90	10.02	8
M 10	0.75	FBA0205999	74.61	33.70	10.29	7.73	10.02	9.2
M 10	1	FBA0206027	74.61	33.70	10.29	7.73	10.02	9
M 10	1.25	FBA0206059	74.61	33.70	10.29	7.73	10.02	8.8
M 12	1	FBA0206260	76.20	31.75	9.32	6.90	10.81	11
M 12	1.25	FBA0206292	76.20	31.75	9.32	6.90	10.81	10.75
M 14	1.25	FBA0206497	76.20	31.75	10.91	8.07	12.40	12.75

CS TAPS



MF

Metric fine threads

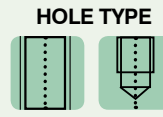
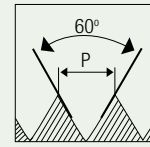

CS

BS 949

ZONE 5

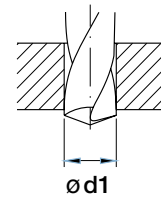
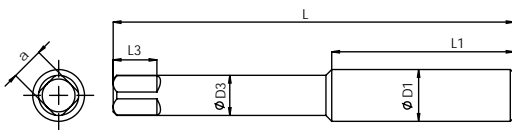

Unit : mm

CS TAPS

Nominal Diameter	Pitch	EDP No.	Overall Length	Thread Length	Shank Diameter	Square Size	Square Length	Tapping Drill Diameter
ØD1	p		L	L1	ØD3	a	L3	Ø d1
M 16	1	FBA0206672	76.20	31.75	12.20	9.04	13.99	15
M 18	1.5	FBA0206927	76.20	31.75	13.78	10.20	15.58	16.5
M 20	1	FBA0207014	82.55	38.10	15.00	11.12	17.16	19
M 22	1.5	FBA0207156	82.55	38.10	17.71	13.17	18.75	20.5
M 24	1.5	FBA0207271	82.55	38.10	19.31	14.37	18.75	22.5
M 25	1.5	FBA0207387	82.55	38.10	20.33	15.13	20.34	23.5
M 26	1.5	FBA0207445	82.35	38.10	20.35	15.13	20.20	24.5
M 27	1.5	FBA0207501	82.35	38.10	20.35	15.13	20.20	25.5
M 28	1.5	FBA0207615	101.40	38.10	21.21	15.77	20.30	26.5
M 30	1.5	FBA0207700	101.40	38.10	22.79	16.96	21.90	28.5
M 30	2	FBA0207729	101.40	38.10	22.79	16.96	21.90	28
M 32	1.5	FBA0207871	101.40	38.10	25.98	19.34	25.20	31.5
M 40	1.5	FBA0208239	101.40	38.10	31.35	23.38	28.20	38



BSW

Whitworth coarse threads

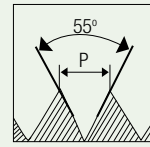

HOLE TYPE



CS

BS 949

ZONE 5

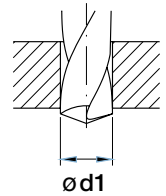
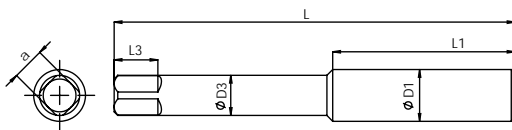

Unit : mm

Nominal Diameter	TPI	EDP No.	Overall Length	Thread Length	Shank Diameter	Square Size	Square Length	Tapping Drill Diameter
ØD1			L	L1	ØD3	a	L3	Ø d1
1/16"	60	FBA0200001	42.19	10.5	3.25	2.58	4.46	-
3/32"	48	FBA0200029	47.41	15	3.25	2.58	4.46	-
1/8"	40	FBA0200057	51.05	18.8	3.25	2.58	4.46	-
5/32"	32	FBA0200085	56.28	22.3	4.04	3.03	6.05	-
3/16"	24	FBA0200113	63.04	26.6	4.8	3.69	6.05	3.7
7/32"	24	FBA0200141	63.56	26.6	5.61	4.3	6.05	4.5
1/4"	20	FBA0200169	67.17	30.7	6.43	4.91	6.84	5.1
9/32"	20	FBA0200197	67.68	30.7	7.21	5.5	7.64	5.8
5/16"	18	FBA0200225	69.85	30.5	8	6.06	8.43	6.5
3/8"	16	FBA0200253	74.61	33.7	9.58	7.38	10.02	7.9
7/16"	14	FBA0200281	80.17	36.5	8.2	6.06	10.02	9.3
1/2"	12	FBA0200309	85.83	42.1	9.32	6.9	10.81	10.5
9/16"	12	FBA0200338	91.28	42	10.91	8.07	12.4	12.1
5/8"	11	FBA0200366	96.84	46	12.2	9.04	13.99	13.5
11/16"	11	FBA0200394	102.4	46	13.78	10.2	15.58	15
3/4"	10	FBA0200422	107.95	50.8	15	11.12	17.16	16.25
7/8"	9	FBA0200478	119.06	56.4	17.71	13.18	18.75	19.25
1"	8	FBA0200534	130.18	63.5	20.33	15.13	20.34	22

CS TAPS



Carbon Steel Hand Taps

BSW

Whitworth coarse threads

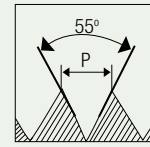

HOLE TYPE

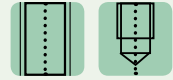

CS

BS
949

ZONE
5

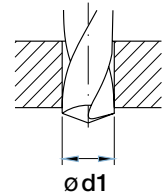
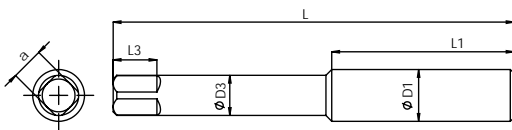

Unit : mm

Nominal Diameter	TPI	EDP No.	Overall Length	Thread Length	Shank Diameter	Square Size	Square Length	Tapping Drill Diameter
			L	L1	ØD3	a	L3	Ø d1
1.1/8"	7	FBA0200562	137.8	65	22.79	16.96	21.7	24.75
1.1/4"	7	FBA0200590	145.8	65	25.96	19.34	25.2	28
1.3/8"	6	FBA0200618	153.8	76	28.17	20.99	26.7	31
1.1/2"	6	FBA0200646	161.8	76	31.35	23.38	28.2	33.5
1.3/4"	5	FBA0200702	177.8	81	36.35	27.12	31.7	39
2"	4.5	FBA0200758	193.3	90.5	41.79	31.21	34.7	44.5

CS TAPS



Carbon Steel Hand Taps

BSF

Whitworth fine threads

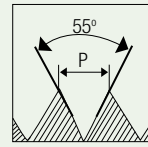

HOLE TYPE



CS

**BS
949**

**ZONE
5**

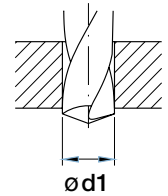
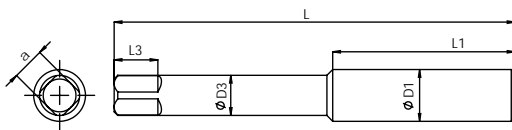

Unit : mm

Nominal Diameter	TPI	EDP No.	Overall Length	Thread Length	Shank Diameter	Square Size	Square Length	Tapping Drill Diameter
ØD1			L	L1	ØD3	a	L3	Ød1
3/16"	32	FBA0200842	63.15	26.6	4.8	3.69	6.05	4
7/32"	28	FBA0200870	63.61	26.6	5.61	4.3	6.05	4.6
1/4"	26	FBA0200898	67.27	30.7	6.43	4.91	6.84	5.3
9/32"	26	FBA0200926	67.79	30.7	7.21	5.5	7.64	6.1
5/16"	22	FBA0200954	69.85	30.5	8	6.06	8.43	6.8
3/8"	20	FBA0200982	74.61	33.7	9.58	7.38	10.02	8.3
7/16"	18	FBA0201011	80.17	36.5	8.2	6.06	10.02	9.7
1/2"	16	FBA0201039	85.83	42.1	9.32	6.9	10.81	11.1
9/16"	16	FBA0201067	91.28	42	10.91	8.07	12.4	12.7
5/8"	14	FBA0201095	96.84	46	12.2	9.04	13.99	14
11/16"	14	FBA0201123	102.4	46	13.78	10.19	15.58	15.5
3/4"	12	FBA0201151	107.95	50.8	15	11.12	17.16	16.75
7/8"	11	FBA0201207	119.06	56.4	17.71	13.18	18.75	19.75
1"	10	FBA0201263	130.18	63.5	20.33	15.13	20.34	22.75
1.1/8"	9	FBA0201291	137.8	65	22.79	16.96	21.7	25.5
1.1/4"	9	FBA0201319	145.8	65	25.96	19.34	25.2	28.5
1.3/8"	8	FBA0201347	153.8	76	28.17	20.99	26.7	31.5
1.1/2"	8	FBA0201375	161.8	76	31.35	23.38	28.2	34.5

CS TAPS



BA British association threads

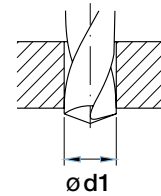
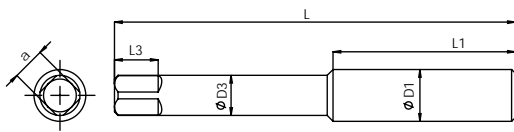
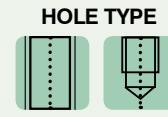
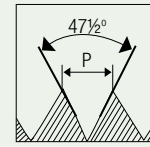

CS TAPS

								Unit : mm
Nominal Diameter	p	EDP No.	Overall Length	Thread Length	Shank Diameter	Square Size	Square Length	Tapping Drill Diameter
ØD1			L	L1	ØD3	a	L3	Ø d1
# 12	0.28	FBA0209359	42.00	10.50	3.25	2.58	4.46	1.05
# 11	0.31	FBA0209387	42.08	10.50	3.25	2.58	4.46	1.2
# 10	0.35	FBA0209415	42.29	11.50	3.25	2.58	4.46	1.4
# 9	0.39	FBA0209443	43.98	11.50	3.25	2.58	4.46	1.55
# 8	0.43	FBA0209471	45.76	15.00	3.25	2.58	4.46	1.8
# 7	0.48	FBA0209499	47.52	15.00	3.25	2.58	4.46	2.05
# 6	0.53	FBA0209527	49.29	17.00	3.25	2.58	4.46	2.3
# 5	0.59	FBA0209555	51.11	18.80	3.25	2.58	4.46	2.65
# 4	0.66	FBA0209583	52.92	20.60	3.66	2.86	4.46	3
# 3	0.73	FBA0209611	56.42	22.50	4.22	3.26	6.05	3.4
# 2	0.81	FBA0209639	63.13	26.60	4.80	3.69	6.05	4
# 1	0.9	FBA0209667	63.47	26.60	5.41	4.15	6.05	4.5
# 0	1	FBA0209695	67.07	30.70	6.15	4.71	6.84	5.1



BSB

British brass threads

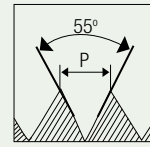

HOLE TYPE



CS

**BS
949**

**ZONE
5**

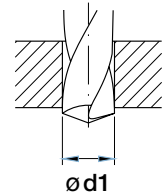
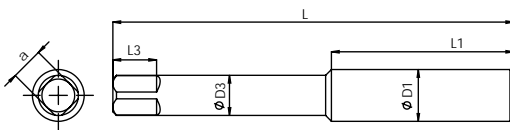

Unit : mm

Nominal Diameter	TPI	EDP No.	Overall Length	Thread Length	Shank Diameter	Square Size	Square Length	Tapping Drill Diameter
ØD1			L	L1	ØD3	a	L3	Ød1
1/4"	26	FBA0201487	67.27	30.7	6.43	4.91	6.84	5.3
5/16"	26	FBA0201515	69.85	30.5	8	6.06	8.43	6.9
3/8"	26	FBA0201543	74.61	33.7	9.58	7.38	10.02	8.4
7/16"	26	FBA0201571	76.2	31.75	8.2	6.06	10.02	9.9
1/2"	26	FBA0201599	76.2	31.75	9.32	6.9	10.81	11.5
9/16"	26	FBA0201627	76.2	31.75	10.91	8.07	12.4	13.1
5/8"	26	FBA0201655	76.2	31.75	12.2	9.04	13.99	14.65
3/4"	26	FBA0201683	82.55	38.1	15	11.12	17.16	17.86
1"	26	FBA0201711	82.55	38.1	20.33	15.13	20.34	17.86

CS TAPS



Carbon Steel Hand Taps

BS Con

British conduit threads

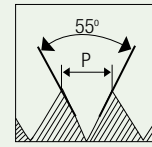

HOLE TYPE

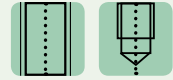

CS

BS
949

ZONE
5

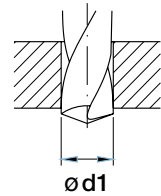
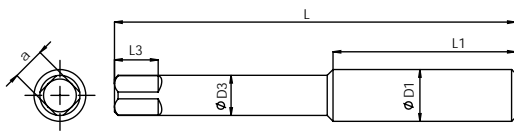

Unit : mm

CS TAPS

Nominal Diameter	TPI	EDP No.	Overall Length	Thread Length	Shank Diameter	Square Size	Square Length	Tapping Drill Diameter
			L	L1	ØD3	a	L3	Ø d1
1/2"	18	FBA0209023	76.2	31.75	9.32	6.9	10.81	11.1
5/8"	18	FBA0209051	76.2	31.75	12.2	9.04	13.99	14
3/4"	16	FBA0209079	82.55	38.1	15	11.12	17.16	17.5
1"	16	FBA0209107	82.55	38.1	20.33	15.13	20.34	23.5



ME

Model engineer threads

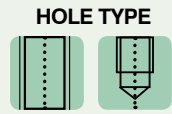
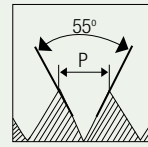

CS

**BS
949**

**ZONE
5**

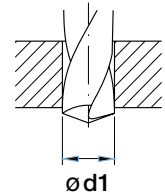
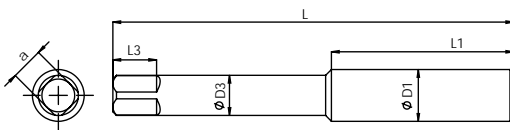

								Unit : mm	
Nominal Diameter	TPI	EDP No.	Overall Length	Thread Length	Shank Diameter	Square Size	Square Length	Tapping Drill Diameter	
ØD1			L	L1	ØD3	a	L3	Ø d1	
1/8"	40	FBA0203295	51.05	18.8	3.25	2.58	4.46	2.55	
5/32"	40	FBA0203323	56.34	22.5	4.04	3.03	6.05	3.25	
3/16"	40	FBA0203351	63.21	26.6	4.8	3.69	6.05	4.1	
7/32"	40	FBA0203379	63.73	26.6	5.61	4.3	6.05	4.9	
1/4"	40	FBA0203407	67.4	30.7	6.43	4.91	6.84	5.8	
9/32"	32	FBA0203435	67.87	30.7	7.21	5.5	7.64	6.1	
5/16"	32	FBA0203463	69.85	30.5	8	6.06	8.43	7.1	
3/8"	32	FBA0203491	74.61	33.7	9.58	7.38	10.02	8.6	

CS TAPS



BS Cy British cycle threads

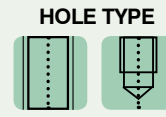
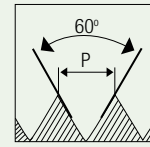

CS
BS 949
ZONE 5
T/S/B

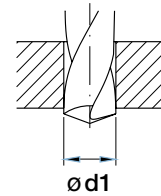
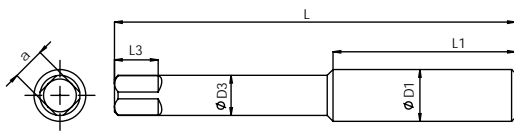

CS TAPS

Unit : mm								
Nominal Diameter	TPI	EDP No.	Overall Length	Thread Length	Shank Diameter	Square Size	Square Length	Tapping Drill Diameter
Ø D1			L	L1	Ø D3	a	L3	Ø d1
3/16"	32	FBA0208435	63.21	26.6	4.8	3.69	6.05	4.1
1/4"	26	FBA0208491	67.36	30.7	6.43	4.91	6.84	5.6
5/16"	26	FBA0208519	69.85	30.5	8	6.06	8.43	7.1
3/8"	26	FBA0208547	74.61	33.7	9.58	7.38	10.02	8.7
7/16"	26	FBA0208575	76.2	31.75	8.2	6.06	10.02	10.3
1/2"	26	FBA0208603	76.2	31.75	9.32	6.9	10.81	11.9



WF

Whitworth fine threads special

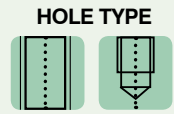
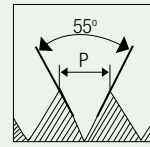

CS

BS 949

ZONE 5

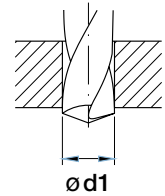
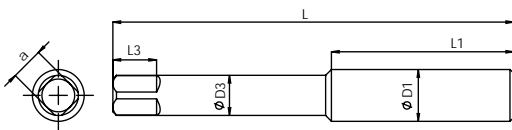

Unit : mm

Nominal Diameter	TPI	EDP No.	Overall Length	Thread Length	Shank Diameter	Square Size	Square Length	Tapping Drill Diameter
ØD1			L	L1	ØD3	a	L3	Ø d1
3/16"	28	FBA0204641	63.1	26.6	4.8	3.69	6.05	
7/32"	32	FBA0204669	63.73	26.6	5.61	4.3	6.05	
1/4"	32	FBA0204697	67.36	30.7	6.43	4.91	6.84	5.6
5/16"	40	FBA0204753	69.85	30.5	8	6.06	8.43	7.3
3/8"	40	FBA0204809	74.61	33.7	9.58	7.38	10.02	8.9
7/16"	40	FBA0204837	76.2	31.75	8.2	6.06	10.02	
7/16"	32	FBA0204865	76.2	31.75	8.2	6.06	10.02	
1/2"	40	FBA0204893	76.2	31.75	9.32	6.9	10.81	
1/2"	32	FBA0204921	76.2	31.75	9.32	6.9	10.81	
11/64"	40	FBA0204473	62.95	26.60	4.80	3.76	6.35	
11/64"	48	FBA0204501	63	26.60	4.80	3.76	6.35	
15/64"	28	FBA0204585	67.04	30.70	6.15	4.78	7.14	
15/64"	40	FBA0204613	67.18	30.70	6.15	4.78	7.14	

CS TAPS



BSP

British standard pipe threads

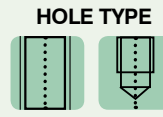
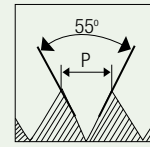

CS
BS 949
ZONE 5
T/B

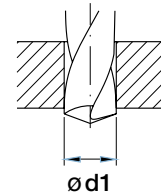
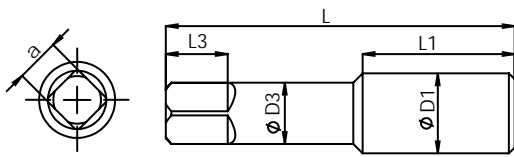

CS TAPS

								Unit : mm
Nominal Diameter	TPI	EDP No.	Overall Length	Thread Length	Shank Diameter	Square Size	Square Length	Tapping Drill Diameter
ØD1			L	L1	ØD3	a	L3	Ø d1
1/8"	28	FBA0208631	53.98	19.05	8.08	5.96	7.64	8.8
1/4"	19	FBA0208659	61.91	26.99	10.91	8.07	10.81	11.8
3/8"	19	FBA0208687	65.09	26.99	13.78	10.2	12.4	15.25
1/2"	14	FBA0208715	79.38	34.92	17.46	12.97	15.58	19
5/8"	14	FBA0208743	80.96	34.92	20.33	15.13	17.16	21
3/4"	14	FBA0208771	82.55	34.92	22.99	17.14	17.16	24.5
7/8"	14	FBA0208799	88.9	39.69	27.74	20.51	18.75	28.25
1"	11	FBA0208827	95.25	44.45	28.56	21.3	20.34	30.75
1.1/4"	11	FBA0208883	101.3	44.5	33.35	24.88	23.7	39.5
1.1/2"	11	FBA0208939	107.8	44.5	38.13	28.46	25.2	45
1.3/4"	11	FBA0208967	110.8	44.5	41.3	30.82	26.7	51
2"	11	FBA0208995	114.3	44.5	47.65	35.54	28.2	57



Carbon Steel Hand Taps

BSPT

British standard taper pipe threads

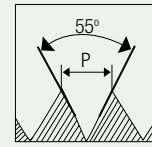

HOLE TYPE



CS

BS
949

ZONE
5

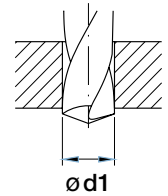
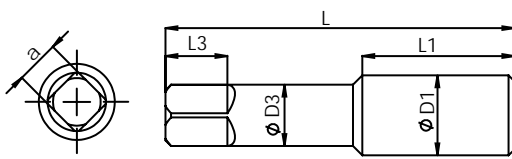

Unit : mm

Nominal Diameter	TPI	EDP No.	Overall Length	Thread Length	Shank Diameter	Square Size	Square Length	Tapping Drill Diameter
ØD1			L	L1	ØD3	a	L3	Ød1
1/8"	28	FBA0209135	54	19.1	8.08	6.05	7.9	8.4
1/4"	19	FBA0209163	61.9	27	10.9	8.18	11.1	11.5
3/8"	19	FBA0209191	65.1	27	13.77	10.31	12.7	14.75
1/2"	14	FBA0209219	79.4	34.9	17.45	13.08	15.9	18.25
5/8"	14	FBA0211009	81	34.9	20.32	15.24	17.5	20.25
3/4"	14	FBA0209247	82.6	34.9	23.01	17.25	17.5	23.4
1"	11	FBA0209275	95.3	44.5	28.58	21.41	20.6	29.75
1.1/4"	11	FBA0209303	101.6	44.5	33.32	24.99	23.8	38.1
1.1/2"	11	FBA0209331	108	44.5	38.1	28.58	25.4	44.5
2"	11	FBA0211037	114.3	44.5	47.63	35.71	28.6	56.4

CS TAPS



UNC

Unified coarse threads

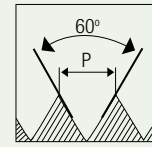

HOLE TYPE

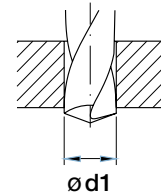
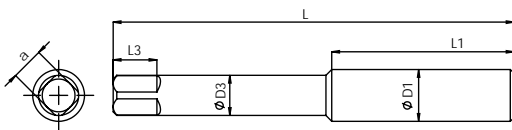

Unit : mm

CS TAPS

Nominal Diameter	TPI	EDP No.	Overall Length	Thread Length	Shank Diameter	Square Size	Square Length	Tapping Drill Diameter
ØD1			L	L1	ØD3	a	L3	Ø d1
# 4	40	FBA0202566	49.26	17	3.58	2.7	4.46	2.35
# 5	40	FBA0202622	51.04	18.8	3.58	2.7	4.46	2.65
# 6	32	FBA0202650	52.79	20.6	3.58	2.7	4.46	2.85
# 8	32	FBA0202706	56.39	22.5	4.27	3.24	6.05	3.5
# 10	24	FBA0202734	63.07	26.6	4.93	3.77	6.05	3.9
# 12	24	FBA0202790	63.5	28.5	5.61	4.1	6.84	4.5
1/4"	20	FBA0202818	67.15	30.7	6.48	4.76	7.64	5.1
5/16"	18	FBA0202846	73.68	35.2	8.08	5.96	9.23	6.6
3/8"	16	FBA0202874	74.61	33.7	9.68	7.17	10.81	8
7/16"	14	FBA0202902	80.17	36.5	8.2	6.06	10.02	9.4
1/2"	13	FBA0202930	85.83	42.1	9.32	6.9	10.81	10.8
9/16"	12	FBA0202958	91.28	42	10.91	8.07	12.4	12.2
5/8"	11	FBA0202986	96.84	46	12.2	9.04	13.99	13.5
3/4"	10	FBA0203042	107.95	50.8	15	11.12	17.16	16.5
7/8"	9	FBA0203070	119.06	56.4	17.71	13.18	18.75	19.5
1"	8	FBA0203098	130.18	63.5	20.33	15.13	20.34	22.25
1.1/8"	7	FBA0203126	137.8	65	22.79	16.96	21.7	25
1.1/4"	7	FBA0203155	145.8	65	25.96	19.34	25.2	28
1.3/8"	6	FBA0203183	153.8	76	28.17	20.99	26.7	30.75
1.1/2"	6	FBA0203211	161.8	76	31.35	23.38	28.2	34
1.3/4"	5	FBA0203239	177.8	81	36.35	27.12	31.7	39.5
2"	4.1/2	FBA0203267	193.7	90.5	41.79	31.21	34.7	45



UNF

Unified fine threads

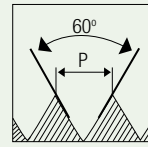

HOLE TYPE



CS

BS 949

2B

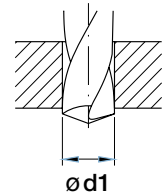
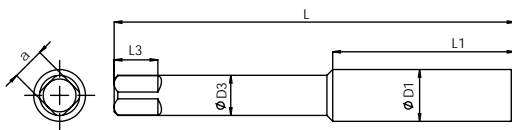

Unit : mm

Nominal Diameter	TPI	EDP No.	Overall Length	Thread Length	Shank Diameter	Square Size	Square Length	Tapping Drill Diameter
ØD1			L	L1	ØD3	a	L3	Ø d1
# 5	44	FBA0201879	51.06	18.8	3.58	2.7	4.46	2.7
# 6	40	FBA0201907	52.85	20.6	3.58	2.7	4.46	2.95
# 8	36	FBA0201963	56.43	22.5	4.27	3.24	6.05	3.5
# 10	32	FBA0201991	63.17	26.6	4.93	3.77	6.05	4.1
# 12	28	FBA0202048	63.56	28.5	5.61	4.1	6.84	4.7
1/8"	44	FBA0201851	51.06	18.8	3.58	2.7	4.46	
5/32"	36	FBA0201935	63.13	22.5	4.27	3.24	6.05	
3/16"	32	FBA0202020	63.13	26.6	4.93	3.77	6.05	
1/4"	28	FBA0202077	67.28	30.7	6.48	4.76	7.64	5.5
5/16"	24	FBA0202106	73.82	35.2	8.08	5.96	9.23	6.9
3/8"	24	FBA0202135	74.61	33.7	9.68	7.17	10.81	8.5
7/16"	20	FBA0202164	80.17	36.5	8.2	6.06	10.02	9.9
1/2"	20	FBA0202193	85.83	42.1	9.32	6.9	10.81	11.5
9/16"	18	FBA0202222	91.28	42	10.91	8.07	12.4	12.9
5/8"	18	FBA0202252	96.84	46	12.2	9.04	13.99	14.5
3/4"	16	FBA0202281	107.95	50.8	15	11.12	17.16	17.5

CS TAPS



Carbon Steel Hand Taps

UNF

Unified fine threads

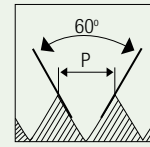

HOLE TYPE

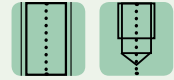

CS

BS
949

2B

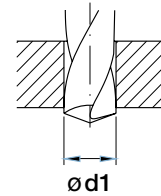
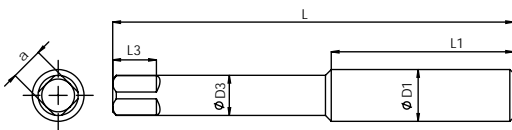

CS TAPS

Nominal Diameter	TPI	EDP No.	Overall Length	Thread Length	Shank Diameter	Square Size	Square Length	Unit : mm
			L	L1	ØD3	a	L3	Tapping Drill Diameter Ø d1
7/8"	14	FBA0202310	119.06	56.4	17.71	13.18	18.75	20.4
1"	12	FBA0202339	130.18	63.5	20.33	15.13	20.34	23.25
1.1/8"	12	FBA0202368	137.8	65	22.79	16.96	21.7	26.5
1.1/4"	12	FBA0202396	145.8	65	25.96	19.34	25.2	29.5
1.3/8"	12	FBA0202425	153.8	76	28.17	20.99	26.7	32.75
1.1/2"	12	FBA0202454	161.8	76	31.35	23.38	28.2	36



NPT

American taper pipe threads

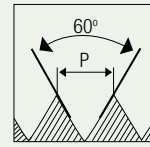

HOLE TYPE



CS

ANSI 94.9

2B

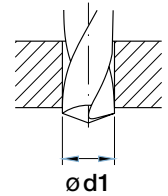
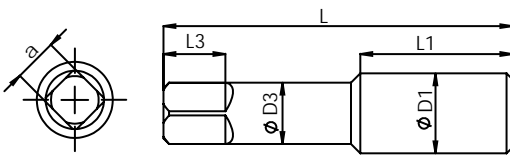

Unit : mm

Nominal Diameter	TPI	EDP No.	Overall Length	Thread Length	Shank Diameter	Square Size	Square Length	Tapping Drill Diameter
Ø D			L	L1	Ø D3	a	L3	Ø d1
1/8"	27	FBA0209891	54	19.1	8.08	6.05	7.9	8.7
1/4"	18	FBA0209919	61.9	27	10.9	8.18	11.1	11.1
3/8"	18	FBA0209947	65.1	27	13.77	10.31	12.7	14.7
1/2"	14	FBA0209975	79.4	34.9	17.45	13.08	15.9	17.9
3/4"	14	FBA0210031	82.6	34.9	23.01	17.25	17.5	23.4
1"	11.1/2	FBA0210059	95.3	44.5	28.58	21.41	20.6	29.4
1.1/4"	11.1/2	FBA0210087	101.6	44.5	33.32	24.99	23.8	38.1
1.1/2"	11.1/2	FBA0210115	108	44.5	38.1	28.58	25.4	44
2"	11.1/2	FBA0210143	114.3	44.5	47.63	35.71	28.6	56.4

CS TAPS



NPS

National pipe threads special

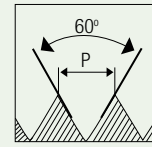

HOLE TYPE



CS
ANSI 949
2B
T/B

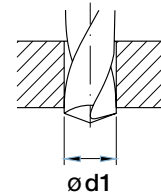
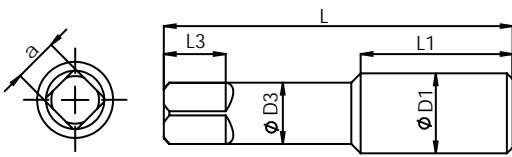

CS TAPS

								Unit : mm
Nominal Diameter	TPI	EDP No.	Overall Length	Thread Length	Shank Diameter	Square Size	Square Length	Tapping Drill Diameter
ØD1			L	L1	ØD3	a	L3	Ø d1
1/8"	27	FBA0209723	53.97	19.05	8.08	5.96	7.64	9.1
1/4"	18	FBA0209751	61.91	26.98	10.91	8.07	10.81	11.9
3/8"	18	FBA0209779	65.09	26.99	13.78	10.2	12.4	15.25
1/2"	14	FBA0209807	79.38	34.92	17.46	12.97	15.58	19
3/4"	14	FBA0209835	82.55	34.92	22.99	17.14	17.16	27
1"	11.5	FBA0209863	95.25	44.45	28.56	21.3	20.34	30.5



UNS

Unified threads special

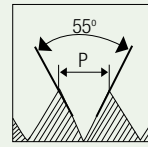

HOLE TYPE



CS

ANSI 949

2B

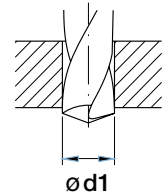
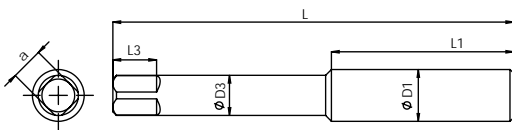

Unit : mm

Nominal Diameter	TPI	EDP No.	Overall Length	Thread Length	Shank Diameter	Square Size	Square Length	Tapping Drill Diameter
ØD1			L	L1	ØD3	a	L3	Ø d1
1/8"	40	FBA0203547	51.04	18.8	3.58	2.7	4.46	
5/32"	32	FBA0203631	56.26	22.5	4.27	3.24	6.05	3.6
5/32"	36	FBA0203659	56.31	22.5	4.27	3.24	6.05	3.65
7/32"	24	FBA0203743	63.55	28.5	5.61	4.1	6.84	
7/32"	28	FBA0203715	63.65	28.5	5.61	4.1	6.84	
7/32"	32	FBA0203771	63.65	28.5	5.61	4.1	6.84	
3/16"	24	FBA0203799	63.03	26.6	4.93	3.77	6.05	4.25
3/16"	32	FBA0203829	63.13	26.6	4.93	3.77	6.05	4.4
1/4"	20	FBA0203857	67.01	30.7	6.48	4.76	7.64	
1/4"	24	FBA0203885	67.23	30.7	6.48	4.76	7.64	
1/4"	32	FBA0203913	67.34	30.7	6.48	4.76	7.64	
5/16"	32	FBA0203941	73.68	35.2	8.08	5.96	10.02	7.5
11/16"	11	FBA0203969	102.4	46	13.78	10.2	15.58	16.4
11/16"	16	FBA0203997	102.4	46	13.78	10.2	15.58	16.7
7/8"	12	FBA0204053	119.06	56.4	17.71	13.18	18.75	
7/8"	18	FBA0204025	119.06	56.4	17.71	13.18	18.75	
1"	14	FBA0204081	130.18	63.5	20.33	15.13	20.34	24.6
1-1/8"	8	FBA0204137	137.8	65	22.79	16.96	21.7	

CS TAPS



UNS

Unified threads special

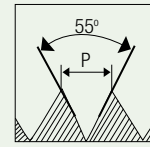

HOLE TYPE

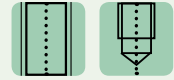

CS

ANSI 949

2B

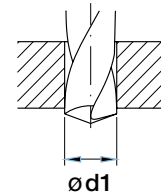
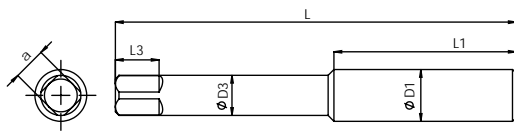

CS TAPS

								Unit : mm
Nominal Diameter	TPI	EDP No.	Overall Length	Thread Length	Shank Diameter	Square Size	Square Length	Tapping Drill Diameter
ØD1			L	L1	ØD3	a	L3	Ø d1
1-1/4"	8	FBA0204165	145.8	65	25.96	19.34	25.2	
1-3/8"	8	FBA0204193	153.8	76	28.17	20.99	26.7	
1-1/2"	8	FBA0204221	161.8	76	31.35	23.38	28.2	
1-5/8"	8	FBA0204249	169.8	81	33.18	24.75	28.2	
1-3/4"	8	FBA0204277	177.8	81	36.35	27.12	31.7	
1-3/4"	12	FBA0204305	177.8	81	36.35	27.12	31.7	
1-7/8"	8	FBA0204333	185.3	90.5	38.61	28.82	31.7	
2"	8	FBA0204389	193.3	90.5	41.79	31.21	34.7	
2"	12	FBA0204417	193.3	90.5	41.79	31.21	34.7	



TAP AND DIE CASE SETS

Description	EDP No	Content
Ref. No METRIC 1 M6-M20 SECS (20Pc)	FBI0200001	"Taps (Second): M6, M8, M10, M12, M14, M16, M20 Dies: 1" OD- M6 TO M10 & 1.1/2" OD - M12 TO M20 Accessories: Tap Wrenches - 2nos. & Die stock - 2nos."
Ref. No METRIC 2 M6-M20 T&B (28Pc)	FBI0200002	"Taps (Taper & Bottom): M6, M8, M10, M12, M14, M16, M20 Dies: 1" OD- M6 TO M10 & 1.1/2" OD - M12 TO M20 Accessories: Tap Wrenches - 2nos. & Die stock - 2nos."
Ref. No METRIC C119 M6-M20 T&B (37Pc)	FBI0200003	"Taps (Taper & Bottom): M6, M7, M8, M9, M10, M11, M12, M14, M16, M20 Dies: 1" OD- M6 TO M10 & 1.1/2" OD - M11 TO M20 Accessories: Tap Wrenches - 2nos. & Die stock - 2nos."
Ref. No METRIC 3 M3-M10 T&B (21Pc)	FBI0200004	"Taps (Taper & Bottom): M3, M4, M5, M6, M8, M10 Dies: 13/16" OD- M3 TO M5 & 1" OD - M6 TO M10 Accessories: Tap Wrenches - 1no. & Die stock - 2nos."
Ref. No METRIC 4P M2-M6 T&B (17Pc)	FBI0200005	"Taps (Taper & Bottom): M2, M3, M4, M5, M6 Dies: 13/16" OD- M2 TO M6 Accessories: Tap Wrenches - 1no. & Die stock - 1no."
Ref. No METRIC 4S M2-M6 SET (22Pc)	FBI0200006	"Taps (Taper, Second & Bottom): M2, M3, M4, M5, M6 Dies: 13/16" OD- M2 TO M6 Accessories: Tap Wrenches - 1no. & Die stock - 1no."
Ref. No METRIC 5F M6-M24 T&B (35Pc)	FBI0200007	"Taps (Taper & Bottom): MF6, MF8, MF10, MF12, MF14, MF16, MF18, MF20, MF22, MF24 Dies: 1" OD- MF6 TO MF10 & 1.1/2" OD - MF12 TO MF20 & 2" OD -MF22 TO MF24 Accessories: Tap Wrenches - 2nos. & Die stock - 3nos."
Ref. No METRIC C120 M6-M24 T&B (44Pc)	FBI0200008	"Taps (Taper & Bottom): M6, M7, M8, M9, M10, M11, M12, M14, M16, M20, M22, M24 Dies: 1" OD- M6 TO M10 & 1.1/2" OD - M11 TO M16 & 2" OD -M18 TO M24 Accessories: Tap Wrenches - 2nos. & Die stock - 3nos."
Ref. No METRIC 5C M6-M24 T&B (35Pc)	FBI0200009	"Taps (Taper & Bottom): M6, M8, M10, M12, M14, M16, M18, M20, M22, M24 Dies: 1" OD- M6 TO M10 & 1.1/2" OD - M12 TO M20 & 2" OD -M22 TO M24 Accessories: Tap Wrenches - 2nos. & Die stock - 3nos."
Ref. No METRIC 6P M3-M12 T&B (24Pc)	FBI0200010	"Taps (Taper & Bottom): M3, M4, M5, M6, M8, M10, M12 Dies: 1" OD- M3 TO M12 Accessories: Tap Wrenches - 2nos. & Die stock - 1nos."
Ref. No METRIC 6S M3-M12 SET (31Pc)	FBI0200011	"Taps (Taper, Second & Bottom): M3, M4, M5, M6, M8, M10, M12 Dies: 1" OD- M3 TO M12 Accessories: Tap Wrenches - 2nos. & Die stock - 1nos."
Ref. No METRIC C114 M2-M12 T&B (36Pc)	FBI0200012	"Taps (Taper, Second & Bottom): M2, M3, M4, M5, M6, M7, M8, M9, M10, M11, M12 Dies: 13/16" OD - M2 TO M6 & 1" OD- M7 TO M12 Accessories: Tap Wrenches - 1nos. & Die stock - 2nos."
Ref. No METRIC 7 M6-M12 T&B (18Pc)	FBI0200013	"Taps (Taper, Second & Bottom): M6, M8, M10, M11, M12 Dies: 1" OD - M6 TO M10 & 1.1/2" OD- M11, M12 Accessories: Tap Wrenches - 1nos. & Die stock - 2nos."
Ref. No METRIC C118 M6-M12 T&B (23Pc)	FBI0200014	"Taps (Taper, Second & Bottom): M6, M7, M8, M9, M10, M11, M12 Dies: 1" OD- M6 TO M12 Accessories: Tap Wrenches - 1nos. & Die stock - 1nos."
Ref. No METRIC 8 M3-M12 T&B (23Pc)	FBI0200015	"Taps (Taper, Second & Bottom): M3, M4, M5, M6, M8, M10, M12 Dies: 1" OD- M3 TO M12 Accessories: Tap Wrenches - 1nos. & Die stock - 1nos."
Ref. No C37 1/4-3/4 BSW T&B (24Pc)	FBI0200016	"Taps (Taper, Second & Bottom): 1/4", 5/16", 3/8", 7/16", 1/2", 5/8", 3/4" Dies: 1" OD- 1/4", 5/16", 3/8" & 1.1/2" OD - 7/16", 1/2", 5/8", 3/4" Accessories: Tap Wrenches - 1nos. & Die stock - 2nos."
Ref. No C37 1/4-3/4 BSF T&B (24Pc)	FBI0200017	"Taps (Taper, Second & Bottom): 1/4", 5/16", 3/8", 7/16", 1/2", 5/8", 3/4" Dies: 1" OD- 1/4", 5/16", 3/8" & 1.1/2" OD - 7/16", 1/2", 5/8", 3/4" Accessories: Tap Wrenches - 1nos. & Die stock - 2nos."



Carbon Steel Hand Taps



TAP AND DIE CASE SETS

Description	EDP No	Content
Ref. No C37 1/4-3/4 NF T&B (24Pc)	FBI0200018	"Taps (Taper, Second & Bottom): 1/4", 5/16", 3/8", 7/16", 1/2", 5/8", 3/4" Dies: 1" OD- 1/4", 5/16", 3/8" & 1.1/2" OD - 7/16", 1/2", 5/8", 3/4" Accessories: Tap Wrenches - 1nos. & Die stock - 2nos."
Ref. No C37 1/4-3/4 NC T&B (24Pc)	FBI0200019	"Taps (Taper, Second & Bottom): 1/4", 5/16", 3/8", 7/16", 1/2", 5/8", 3/4" Dies: 1" OD- 1/4", 5/16", 3/8" & 1.1/2" OD - 7/16", 1/2", 5/8", 3/4" Accessories: Tap Wrenches - 1nos. & Die stock - 2nos."
Ref. No INCHES 9 1/4-3/4 BSW T&B (28Pc)	FBI0200020	"Taps (Taper, Second & Bottom): 1/4", 5/16", 3/8", 1/2", 9/16", 5/8", 11/16", 3/4" Dies: 1" OD- 1/4", 5/16", 3/8" & 1.1/2" OD - 9/16", 5/8", 11/16", 3/4" Accessories: Tap Wrenches - 2nos. & Die stock - 2nos."
Ref. No INCHES 9 1/4-3/4 BSF T&B (28Pc)	FBI0200021	"Taps (Taper, Second & Bottom): 1/4", 5/16", 3/8", 1/2", 9/16", 5/8", 11/16", 3/4" Dies: 1" OD- 1/4", 5/16", 3/8" & 1.1/2" OD - 9/16", 5/8", 11/16", 3/4" Accessories: Tap Wrenches - 2nos. & Die stock - 2nos."
Ref. No INCHES 9 1/4-3/4 NC T&B (28Pc)	FBI0200022	"Taps (Taper, Second & Bottom): 1/4", 5/16", 3/8", 1/2", 9/16", 5/8", 11/16", 3/4" Dies: 1" OD- 1/4", 5/16", 3/8" & 1.1/2" OD - 9/16", 5/8", 11/16", 3/4" Accessories: Tap Wrenches - 2nos. & Die stock - 2nos."
Ref. No C31 1/8-1/2 BSW T&B (24Pc)	FBI0200023	"Taps (Taper, Second & Bottom): 1/8", 3/16", 1/4", 5/16", 3/8", 7/16", 1/2" Dies: 13/16" OD- 1/8", 3/16" & 1" OD - 1/4", 5/16", 3/8", 7/16", 1/2" Accessories: Tap Wrenches - 1nos. & Die stock - 2nos."
Ref. No C82 1/4-1/2 BSW T&B (17Pc)	FBI0200024	"Taps (Taper, Second & Bottom): 1/4", 5/16", 3/8", 7/16", 1/2" Dies: 1" OD- 1/4", 5/16", 3/8", 7/16", 1/2" Accessories: Tap Wrenches - 1nos. & Die stock - 1nos."
Ref. No C82 1/4-1/2 BSF T&B (17Pc)	FBI0200025	"Taps (Taper, Second & Bottom): 1/4", 5/16", 3/8", 7/16", 1/2" Dies: 1" OD- 1/4", 5/16", 3/8", 7/16", 1/2" Accessories: Tap Wrenches - 1nos. & Die stock - 1nos."
Ref. No C82 1/4-1/2 NF T&B (17Pc)	FBI0200026	"Taps (Taper, Second & Bottom): 1/4", 5/16", 3/8", 7/16", 1/2" Dies: 1" OD- 1/4", 5/16", 3/8", 7/16", 1/2" Accessories: Tap Wrenches - 1nos. & Die stock - 1nos."
Ref. No C82 1/4-1/2 NC T&B (17Pc)	FBI0200027	"Taps (Taper, Second & Bottom): 1/4", 5/16", 3/8", 7/16", 1/2" Dies: 1" OD- 1/4", 5/16", 3/8", 7/16", 1/2" Accessories: Tap Wrenches - 1nos. & Die stock - 1nos."
Ref. No C52 3/16-1/2 BSW T&B (20Pc)	FBI0200028	"Taps (Taper, Second & Bottom): 3/16", 1/4", 5/16", 3/8", 7/16", 1/2" Dies: 1" OD - 3/16", 1/4", 5/16", 3/8", 7/16", 1/2" Accessories: Tap Wrenches - 1nos. & Die stock - 1nos."
Ref. No C52 3/16-1/2 BSF T&B (20Pc)	FBI0200029	"Taps (Taper, Second & Bottom): 3/16", 1/4", 5/16", 3/8", 7/16", 1/2" Dies: 1" OD - 3/16", 1/4", 5/16", 3/8", 7/16", 1/2" Accessories: Tap Wrenches - 1nos. & Die stock - 1nos."
Ref. No C85 1/4-1" BSW T&B (32Pc)	FBI0200030	"Taps (Taper, Second & Bottom): 1/4", 5/16", 3/8", 7/16", 1/2", 5/8", 3/4", 7/8", 1" Dies: 1" OD- 1/4", 5/16", 3/8" & 1.1/2" OD - 7/16", 1/2", 5/8" & 2" OD- 3/4", 7/8", 1" Accessories: Tap Wrenches - 2nos. & Die stock - 3nos."
Ref. No C85 1/4-1" BSF T&B (32Pc)	FBI0200031	"Taps (Taper, Second & Bottom): 1/4", 5/16", 3/8", 7/16", 1/2", 5/8", 3/4", 7/8", 1" Dies: 1" OD- 1/4", 5/16", 3/8" & 1.1/2" OD - 7/16", 1/2", 5/8" & 2" OD- 3/4", 7/8", 1" Accessories: Tap Wrenches - 2nos. & Die stock - 3nos."
Ref. No C85 1/4-1" NF T&B (32Pc)	FBI0200032	"Taps (Taper, Second & Bottom): 1/4", 5/16", 3/8", 7/16", 1/2", 5/8", 3/4", 7/8", 1" Dies: 1" OD- 1/4", 5/16", 3/8" & 1.1/2" OD - 7/16", 1/2", 5/8" & 2" OD- 3/4", 7/8", 1" Accessories: Tap Wrenches - 2nos. & Die stock - 3nos."
Ref. No C85 1/4-1" NC T&B (32Pc)	FBI0200033	"Taps (Taper, Second & Bottom): 1/4", 5/16", 3/8", 7/16", 1/2", 5/8", 3/4", 7/8", 1" Dies: 1" OD- 1/4", 5/16", 3/8" & 1.1/2" OD - 7/16", 1/2", 5/8" & 2" OD- 3/4", 7/8", 1" Accessories: Tap Wrenches - 2nos. & Die stock - 3nos."



Carbon Steel Hand Taps



ADJUSTABLE TAP WRENCHES (FORGED STEEL)

Tap Capacity		EDP No.	Overall Nominal Length	
Inch	mm		Inch	mm
1/16"- 1/4"	2 - 6	FBN2200009	6- 1/4"	172
1/8"- 1/2"	3 - 12	FBN2200010	8-1/16"	205
5/32"- 3/8"	4 - 10	FBN2200011	8-1/16"	205
3/16"- 1/2"	5 - 12	FBN2200012	10-3/16"	258
3/16"-5/8"	5 - 16	FBN2200013	10-1/4"	264
1/4"-3/4"	6 - 20	FBN2200014	13-3/4"	350
5/16"-1"	8 - 25	FBN2200015	17-1/4"	435
3/8"-1"	10 - 25	FBN2200016	17-5/16"	440
3/4"-1.1/2"	18 - 38	FBN2200017	27"	685
1"-2"	25 - 50	FBN2200018	34-1/2"	875

T-HANDLE TAP WRENCHES

Tap Capacity		EDP No.	Overall Nominal Length	
Inch	mm		Inch	mm
1/16"-5/32"	2 - 4	FBN2200019	2-3/8"	60
5/32"-1/4"	4 - 6	FBN2200020	2-11/16"	69
3/16"-5/16"	5 - 8	FBN2200021	2-5/32"	80
1/4"-1/2"	6 - 12	FBN2200022	3-1/2"	88

CS TAPS

T-HANDLE TAP WRENCHES RACHET TYPE

Tap Capacity		EDP No.	Overall Nominal Length	
Inch	mm		Inch	mm
5/32"-1/4"	4 - 6	FBN2200023	2-11/16"	69
1/4"-1/2"	6 - 12	FBN2200024	3-1/2"	88
5/32"-1/4"	4 - 6	ABM000022	10-1/4"	260
1/4"-1/2"	6 - 12	ABM000023	12"	305

DIE STOCKS

Tap Capacity		EDP No.	Overall Nominal Length	
Inch	mm		Inch	mm
13/16"	20	FBN2200001	6-3/4"	170
1"	25	FBN2200002	8-3/4"	222
1.5/16"	33	FBN2200003	10"	254
1.1/2"	38	FBN2200004	12-1/2"	317
2"	50	FBN2200005	15-9/16"	395
2.1/4"	57	FBN2200006	16.1/2"	420
2.1/2"	63	FBN2200007	19"	480
3"	75	FBN2200008	22-1/2"	572
4"	100	FBN2200028	35"	890

CARBON STEEL TAPS NOMENCLATURE

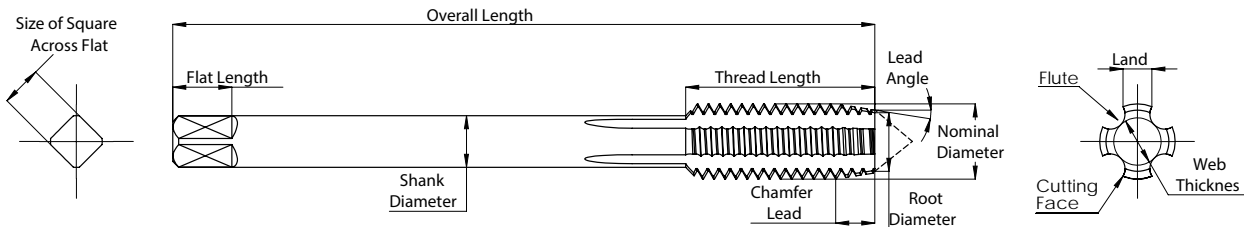

CARBON TAPS APPLICATION

AUTOMOBILE INDUSTRY

- Cylinder liner and Cylinder head manufacturers
- General purpose applications in small workshops, garages, tool rooms and maintenance departments
- Motor cycle body frames: Spatter cleaning and removing paint from threaded portion.
- Carburetor and speedometer manufacturers
- High Speed Steel Dies are used in removing paint from threaded portion in rear axles of cars, trucks, buses, etc.
- Dies are used by gas valve manufacturers.

ENGINEERING INDUSTRY

- Air Compressors / Blower manufacturers
- Cooling towers and heat exchangers
- Brass component manufacturers
- Pipe and Pipe fitting manufacturers.
- Sheet Metal Industry
- Thread dressing of diesel engine components
- Steel furniture manufacturers
- Steel window manufacturers
- Bus and Truck body building workshops
- Textile industry
- Electrical industry

HOUSEHOLD APPLIANCE MANUFACTURERS

- Pressure cookers
- Fans, Air coolers, Air conditioners
- Flour mills, Mixers and Grinders



High Performance Cutting Tools



**HSS & CARBON STEEL
ROUND & HEXAGONAL DIES**



ROUND SPLIT DIES

MATERIAL		THREAD FORM	STANDARD	TOLERANCE	PAGE
CS	HSS	M	BS1127	6G	6.004
CS	HSS	MF	BS1127	6G	6.006
CS	HSS	BSW	BS1127	6G	6.010
CS	HSS	BSF	BS1127	6G	6.012
CS	HSS	BA	BS1127	6G	6.014
CS	HSS	BSB	BS1127	6G	6.015
CS	HSS	ME	BS1127	6G	6.016
CS	HSS	WF	BS1127	6G	6.017
CS	HSS	BSP	BS1127	6G	6.018
CS	HSS	BSPT	BS1127	6G	6.019
CS	HSS	UNC	BS1127	2A	6.020
CS	HSS	UNF	BS1127	2A	6.022



ROUND SOLID DIES

MATERIAL		THREAD FORM	STANDARD	TOLERANCE	PAGE
CS	HSS	NPT	BS1127	2A	6.024
CS	HSS	M	BS1127	6G	6.025
CS	HSS	MF	BS1127	6G	6.026

HEXAGONAL DIES

MATERIAL		THREAD FORM	STANDARD	TOLERANCE	PAGE
CS	HSS	M	BS1127	6G	6.028
CS	HSS	MF	BS1127	6G	6.029
CS	HSS	BSW	BS1127	6G	6.031
CS	HSS	BSF	BS1127	6G	6.032
CS	HSS	BSP	BS1127	2A	6.033
CS	HSS	BSPT	BS1127	2A	6.034
CS	HSS	UNC	BS1127	2A	6.035
CS	HSS	UNF	BS1127	2A	6.036
CS	HSS	NPT	BS1127	2A	6.037

M

Metric coarse threads

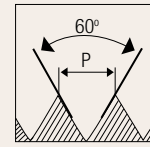

HSS

CS

BS
1127

6G

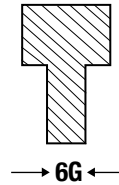
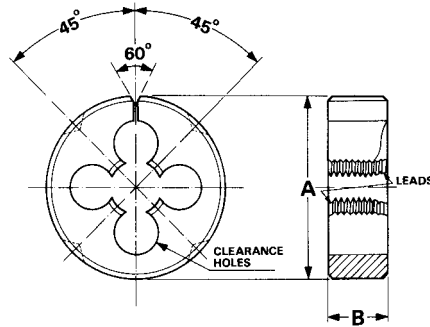

Unit : mm

Nominal Diameter	Pitch	Outer Diameter	HSS	Carbon Steel	Thickness	Clearance Holes	Threading Diameter
ØD	p	A	EDP No.	EDP No.	B		
M 2	0.4	13/16"	FBC0201098	FBB0201147	1/4"	3	1.96
M 3	0.5	13/16"	FBC0201150	FBB0201196	1/4"	3	2.95
M 4	0.7	13/16"	FBC0201196	FBB0201248	1/4"	3	3.95
M 5	0.8	13/16"	FBC0201253	FBB0201310	1/4"	3	4.95
M 6	1	13/16"	FBC0201334	FBB0201371	1/4"	4	5.93
M 7	1	13/16"	FBC0201385	FBB0201407	1/4"	4	6.93
M 6	1	1"	FBC0201346	FBB0201380	3/8"	4	5.93
M 7	1	1"	FBC0201391	FBB0201416	3/8"	4	6.93
M 8	1.25	1"	FBC0201432	FBB0201456	3/8"	4	7.92
M 9	1.25	1"	FBC0201470	FBB0201496	3/8"	4	8.93
M 10	1.5	1"	FBC0201538	FBB0201560	3/8"	4	9.91
M 12	1.75	1.1/2"	FBC0201663	FBB0201697	1/2"	4	11.90
M 14	2	1.1/2"	FBC0201734	FBB0201762	1/2"	5	13.89
M 16	2	1.1/2"	FBC0201803	FBB0201826	1/2"	5	15.89
M 18	2.5	1.1/2"	FBC0201838	FBB0201880	1/2"	6	17.88
M 20	2.5	1.1/2"	FBC0201904	FBB0201926	1/2"	6	19.88

DIES

M

Metric coarse threads

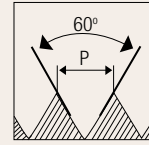

HSS

CS

BS
1127

6G

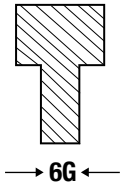
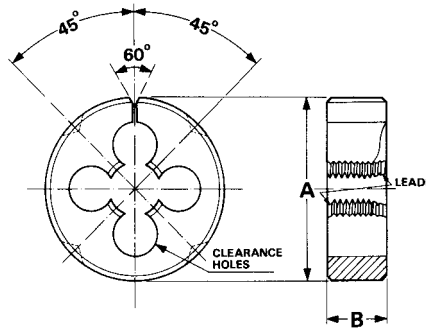

Unit : mm

Nominal Diameter	Pitch	Outer Diameter	HSS	Carbon Steel	Thickness	Clearance Holes	Threading Diameter
ØD	p	A	EDP No.	EDP No.	B		
M 20	2.5	2"	FBC0201910	FBB0201931	5/8"	5	19.88
M 22	2.5	2"	FBC0201934	FBB0201949	5/8"	5	21.88
M 24	3	2"	FBC0201958	FBB0201968	5/8"	5	23.88
M 27	3	2.1/4"	FBM2300071	FBM2300344	11/16"	6	
M 30	3.5	2.1/4"	FBM2300084	FBM2300364	11/16"	6	
M 33	3.5	2.1/4"	FBM2300094	FBM2300377	11/16"	6	
M 36	4	2.1/2"	FBM2300106	FBM2300391	7/8"	6	
M 36	4	3"	FBM2300107	FBM2300392	7/8"	6	
M 39	4	3"	FBM2300113	FBM2300402	7/8"	6	
M 42	4.5	3"	FBM2300120	FBM2300408	7/8"	6	
M 48	5	4"	FBM2300130	FBM2300413	1"	6	

MF

Metric fine threads

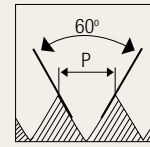

HSS

CS

BS
1127

6G

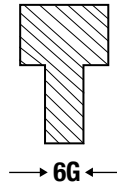
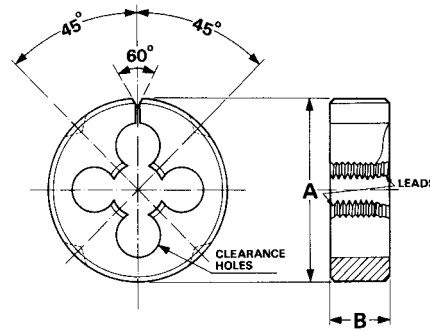

Unit : mm

Nominal Diameter	Pitch	Outer Diameter	HSS	Carbon Steel	Thickness	No. Clearance Hole	Threading Diameter
ØD	p	A	EDP No.	EDP No.	B		
M 1.6	0.35	13/16"	FBC0201092	FBB0201143	1/4"	3	1.56
M 2.2	0.45	13/16"	FBC0201109	FBB0201160	1/4"	3	2.15
M 2.3	0.4	13/16"	FBC0201115	FBB0201169	1/4"	3	2.25
M 2.5	0.45	13/16"	FBC0201121	FBB0201173	1/4"	3	2.45
M 2.6	0.45	13/16"	FBC0201132	FBB0201182	1/4"	3	2.55
M 3	0.6	13/16"	FBC0201161	FBB0201209	1/4"	3	2.96
M 3.5	0.6	13/16"	FBC0201167	FBB0201218	1/4"	3	3.46
M 4	0.5	13/16"	FBC0201184	FBB0201231	1/4"	3	3.95
M 4	0.75	13/16"	FBC0201212	FBB0201261	1/4"	3	3.95
M 4.5	0.5	13/16"	FBC0201218	FBB0201270	1/4"	3	4.45
M 4.5	0.75	13/16"	FBC0201224	FBB0201275	1/4"	3	4.45
M 5	0.5	13/16"	FBC0201235	FBB0201284	1/4"	3	4.95
M 5	0.75	13/16"	FBC0201241	FBB0201297	1/4"	3	4.95
M 5	0.9	13/16"	FBC0201274	FBB0201323	1/4"	3	4.95
M 5.5	0.5	13/16"	FBC0201280	FBB0201331	1/4"	4	5.45
M 5.5	0.9	13/16"	FBC0201292	FBB0201335	1/4"	4	5.45
M 6	0.5	13/16"	FBC0201298	FBB0201343	1/4"	4	5.95
M 6	0.75	13/16"	FBC0201310	FBB0201353	1/4"	4	5.95
M 7	0.75	13/16"	FBC0201373	FBB0201393	1/4"	4	6.95

DIES

MF

Metric fine threads

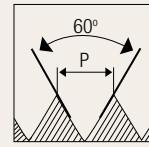

HSS CS BS 1127 6G

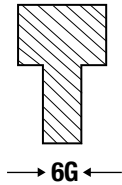
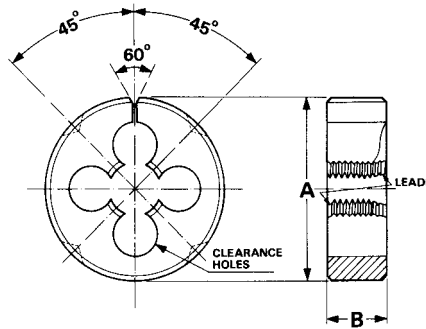

Unit : mm

Nominal Diameter	Pitch	Outer Diameter	HSS	Carbon Steel	Thickness	No. Clearance Hole	Threading Diameter
ØD	p	A	EDP No.	EDP No.	B		
M 6	0.5	1"	FBC0201304	FBB0201348	3/8"	4	5.95
M 6	0.75	1"	FBC0201316	FBB0201358	3/8"	4	5.95
M 7	0.75	1"	FBC0201379	FBB0201398	3/8"	4	6.95
M 8	0.75	1"	FBC0201408	FBB0201429	3/8"	4	7.97
M 8	1	1"	FBC0201420	FBB0201434	3/8"	4	7.93
M 9	0.75	1"	FBC0201453	FBB0201482	3/8"	4	8.95
M 9	1	1"	FBC0201464	FBB0201487	3/8"	4	8.93
M 10	0.5	1"	FBC0201481	FBB0202548	3/8"	4	9.93
M 10	0.75	1"	FBC0201487	FBB0201509	3/8"	4	9.95
M 10	1	1"	FBC0201499	FBB0201518	3/8"	4	9.93
M 10	1.25	1"	FBC0201516	FBB0201535	3/8"	4	9.93
M 11	1	1.1/2"	FBC0201554	FBB0201597	1/2"	5	10.93
M 11	1.5	1.1/2"	FBC0201576	FBB0201613	1/2"	4	10.91
M 12	1	1.1/2"	FBC0201604	FBB0201634	1/2"	5	11.93
M 12	1.25	1.1/2"	FBC0201620	FBB0201647	1/2"	5	11.92
M 12	1.5	1.1/2"	FBC0201636	FBB0201668	1/2"	4	11.91
M 14	1	1.1/2"	FBC0201685	FBB0201726	1/2"	5	13.93
M 14	1.25	1.1/2"	FBC0201696	FBB0201731	1/2"	5	13.92

DIES

MF

Metric fine threads

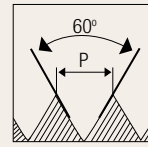

HSS

CS

BS
1127

6G

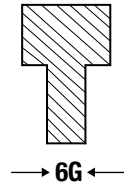
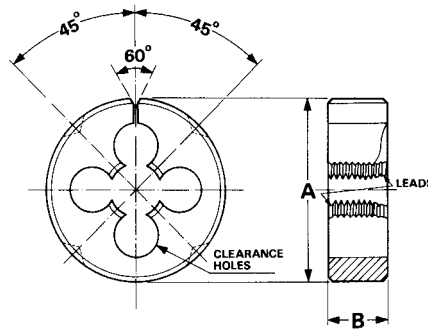

Unit : mm

DIES

Nominal Diameter	Pitch	Outer Diameter	HSS	Carbon Steel	Thickness	No. Clearance Hole	Threading Diameter
ØD	p	A	EDP No.	EDP No.	B		
M 14	1.5	1.1/2"	FBC0201707	FBB0201744	1/2"	5	13.91
M 15	1.5	1.1/2"	FBC0201757	FBB0201786	1/2"	5	14.91
M 16	1	1.1/2"	FBC0201763	FBB0201795	1/2"	5	15.93
M 16	1.5	1.1/2"	FBC0201781	FBB0201813	1/2"	5	15.91
M 18	1.5	1.1/2"	FBC0201820	FBB0201861	1/2"	6	17.91
M 20	1.5	1.1/2"	FBC0201874	FBB0201902	1/2"	6	19.91
M 20	1.5	2"	FBC0201880	FBB0201907	5/8"	5	19.91
M 22	1.5	2"	FBC0201922	FBB0201940	5/8"	6	21.91
M 24	1	2"	FBC0201940	FBB0201953	5/8"	6	23.93
M 24	1.5	2"	FBC0201946	FBB0201958	5/8"	6	23.90
M 25	1.5	2"	FBC0201970	FBB0201977	5/8"	6	24.91
M 26	1.5	2"	FBC0201988	FBB0201986	5/8"	6	25.90
M 27	1.5	2"	FBC0202000	FBB0202641	5/8"	6+6	26.9
M 28	1.5	2"	FBC0202012	FBB0202711	5/8"	6+6	27.9
M 30	1.5	2"	FBC0202024	FBB0201991	5/8"	6+6	29.9
M 32	1.5	2.1/4"	FBM2300087	FBM2300368	11/16"	6+6	
M 33	1.5	2.1/4"	FBM2300091	FBM2300595	11/16"	6+6	

MF

Metric fine threads

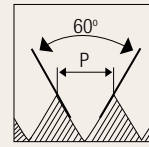

HSS
CS
BS 1127
6G

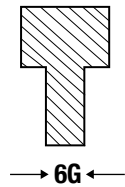
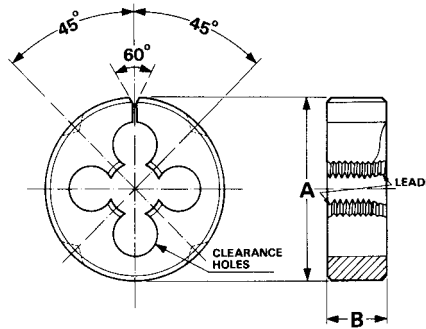

Unit : mm

Nominal Diameter	Pitch	Outer Diameter	HSS	Carbon Steel	Thickness	No. Clearance Hole	Threading Diameter
ØD	p	A	EDP No.	EDP No.	B		
M 34	1.5	2.1/2"	FBM2300097	FBM2300381	7/8"	6	
M 35	1.5	2.1/2"	FBM2300100	FBM2300383	7/8"	6	
M 36	1.5	2.1/2"	FBM2300102	FBM2300385	7/8"	6	
M 40	1.5	2.1/2"	FBM2300114	FBM2300404	7/8"	6	
M 34	1.5	3"	FBM2300098	FBM2300382	7/8"	6	
M 35	1.5	3"	FBM2300101	FBM2300384	7/8"	6	
M 36	1.5	3"	FBM2300103	FBM2300386	7/8"	6	
M 38	1.5	3"	FBM2300109	FBM2300396	7/8"	6	
M 45	1.5	3"	FBM2300123	-	7/8"	6	
M 45	1.5	4"	FBM2300124	FBM2300410	1"	6	
M 46	1.5	4"	FBM2300126	FBM2300411	1"	6	
M 48	1.5	4"	FBM2300127	FBM2300412	1"	8	
M 50	1.5	4"	FBM2300131	FBM2300414	1"	6	
M 52	1.5	4"	FBM2300132	FBM2300415	1"	6	
M 55	1.5	4"	FBM2300133	FBM2300416	1"	6	
M 60	1.5	4"	FBM2300134	FBM2300418	1"	6	

DIES



BSW

Whitworth coarse threads

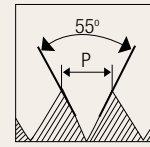

HSS
CS
BS 1127
6G

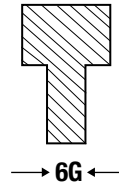
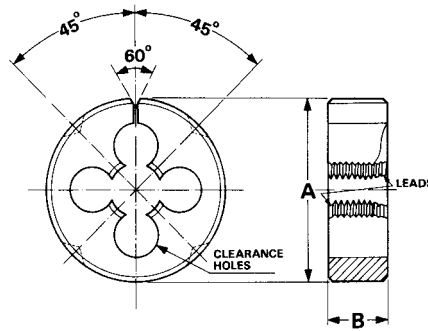

Unit : mm

Nominal Diameter	TPI	Outer Diameter	HSS	Carbon Steel	Thickness	No. Clearance Hole	Threading Diameter
ØD		A	EDP No.	EDP No.	B		
1/16"	60	13/16"	FBC0200001	FBB0200001	1/4"	3	1.56
3/32"	48	13/16"	FBC0200007	FBB0200005	1/4"	3	2.35
1/8"	40	13/16"	FBC0200013	FBB0200017	1/4"	3	3.14
5/32"	32	13/16"	FBC0200019	FBB0200034	1/4"	3	3.93
3/16"	24	13/16"	FBC0200036	FBB0200051	1/4"	3	4.72
7/32"	24	13/16"	FBC0200047	FBB0200064	1/4"	4	5.51
1/4"	20	13/16"	FBC0200059	FBB0200081	1/4"	4	6.31
1/4"	20	1"	FBC0200071	FBB0200090	3/8"	3	6.31
9/32"	20	1"	FBC0200089	FBB0200111	3/8"	4	7.10
5/16"	18	1"	FBC0200101	FBB0200119	3/8"	4	7.88
3/8"	16	1"	FBC0200128	FBB0200144	3/8"	4	9.47
7/16"	14	1.1/2"	FBC0200159	FBB0200173	1/2"	4	11.05
1/2"	12	1.1/2"	FBC0200181	FBB0200197	1/2"	4	12.63
9/16"	12	1.1/2"	FBC0200198	FBB0200210	1/2"	5	14.21
5/8"	11	1.1/2"	FBC0200210	FBB0200223	1/2"	5	15.80
11/16"	11	1.1/2"	FBC0200221	FBB0200232	1/2"	6	17.39
3/4"	10	1.1/2"	FBC0200233	FBB0200244	1/2"	6	18.97

DIES

BSW

Whitworth coarse threads

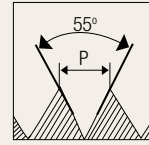

HSS

CS

BS
1127

6G

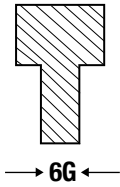
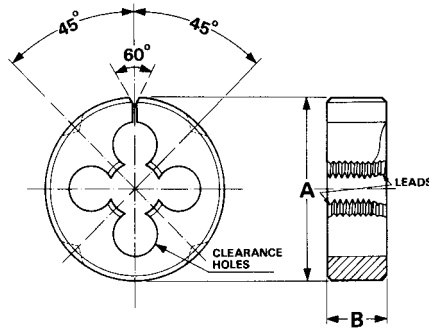

Unit : mm

Nominal Diameter ØD	TPI	Outer Diameter A	HSS	Carbon Steel	Thickness B	No. Clearance Hole	Threading Diameter
			EDP No.	EDP No.			
7/8"	9	2"	FBC0200245	FBB0200253	5/8"	5	22.14
1"	8	2"	FBC0200251	FBB0200257	5/8"	6	25.30
1.1/8"	7	2.1/4"	FBM2300001	FBM2300297	11/16"	6	
1.1/4"	7	2.1/4"	FBM2300004	FBM2300299	11/16"	6	
1.1/4"	7	2.1/2"	FBM2300005	FBM2300300	7/8"	6	
1.3/8"	6	2.1/2"	FBM2300010	FBM2300301	7/8"	6	
1.1/2"	6	2.1/2"	FBM2300012	FBM2300302	7/8"	6	
1.1/2"	6	3"	FBM2300013	FBM2300303	7/8"	6	
1.3/4"	5	4"	FBM2300014	FBM2300304	1"	6	
2"	4.5	4"	FBM2300015	FBM2300305	1"	6	

BSF

Whitworth fine threads

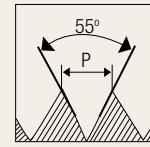

HSS

CS

BS
1127

6G

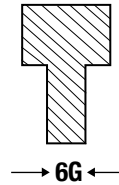
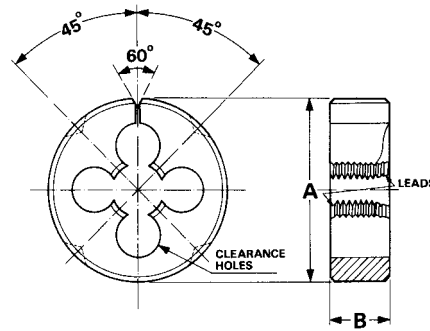

Unit : mm

Nominal Diameter ØD	TPI	Outer Diameter A	HSS	Carbon Steel	Thickness B	No. Clearance Hole	Threading Diameter
			EDP No.	EDP No.			
3/16"	32	13/16"	FBC0200257	FBB0200261	1/4"	3	4.73
7/32"	28	13/16"	FBC0200263	FBB0200270	1/4"	4	5.51
1/4"	26	13/16"	FBC0200269	FBB0200279	1/4"	4	6.31
1/4"	26	1"	FBC0200275	FBB0200283	3/8"	4	6.31
9/32"	26	1"	FBC0200281	FBB0200299	3/8"	4	7.1
5/16"	22	1"	FBC0200287	FBB0200303	3/8"	4	7.89
3/8"	20	1"	FBC0200293	FBB0200320	3/8"	4	9.47
7/16"	18	1.1/2"	FBC0200314	FBB0200341	1/2"	4	11.05
1/2"	16	1.1/2"	FBC0200330	FBB0200349	1/2"	4	12.63
9/16"	16	1.1/2"	FBC0200336	FBB0200358	1/2"	5	14.22
5/8"	14	1.1/2"	FBC0200342	FBB0200366	1/2"	5	15.80
3/4"	12	1.1/2"	FBC0200353	FBB0200383	1/2"	5	18.97
7/8"	11	2"	FBC0200359	FBB0200391	5/8"	5	22.14
1"	10	2"	FBC0200365	FBB0200395	5/8"	6	25.30
1.1/8"	9	2.1/4"	FBM2300016	FBM2300306	11/16"	6	

DIES

BSF

Whitworth fine threads

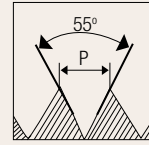

HSS

CS

BS
1127

6G

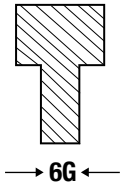
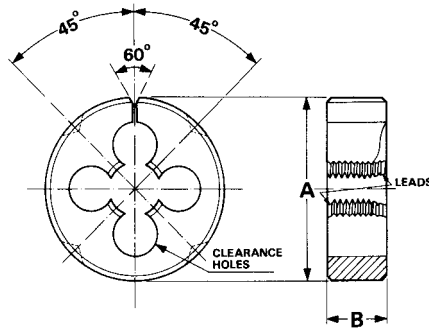

Unit : mm

Nominal Diameter	TPI	Outer Diameter	HSS	Carbon Steel	Thickness	No. Clearance Hole	Threading Diameter
ØD		A	EDP No.	EDP No.	B		
1.1/4"	9	2.1/4"	FBM2300020	FBM2300308	11/16"	6	
1.3/8"	8	2.1/2"	FBM2300025	FBM2300310	7/8"	6	
1.1/2"	8	2.1/2"	FBM2300027	FBM2300311	7/8"	6	
1.1/2"	8	3"	FBM2300028	FBM2300312	7/8"	6	
1.3/4"	7	4"	FBM2300029	FBM2300313	1"	6	
2"	7	4"	FBM2300030	-	1"	6	

DIES

BA

British association threads

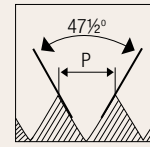

HSS

CS

BS
1127

6G

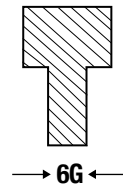
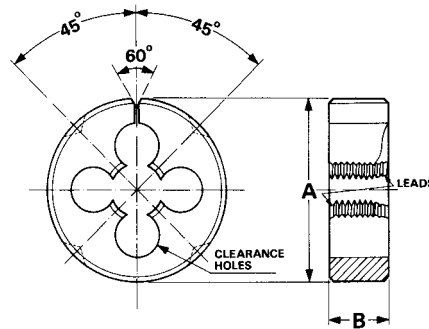

Unit : mm

Nominal Diameter ØD	TPI	Outer Diameter A	HSS	Carbon Steel	Thickness B	No. Clearance Hole	Threading Diameter
			EDP No.	EDP No.			
# 12	90.9	13/16"	FBC0202220	FBB0202153	1/4"	3	1.27
# 11	81.9	13/16"	FBC0202226	FBB0202158	1/4"	3	1.47
# 10	72.6	13/16"	FBC0202232	FBB0202163	1/4"	3	1.67
# 9	65.1	13/16"	FBC0202238	FBB0202168	1/4"	3	1.87
# 8	59.1	13/16"	FBC0202244	FBB0202173	1/4"	3	2.16
# 7	52.9	13/16"	FBC0202250	FBB0202178	1/4"	3	2.46
# 6	47.9	13/16"	FBC0202256	FBB0202183	1/4"	3	2.76
# 5	43	13/16"	FBC0202262	FBB0202188	1/4"	3	3.15
# 4	38.5	13/16"	FBC0202268	FBB0202193	1/4"	3	3.55
# 3	34.8	13/16"	FBC0202274	FBB0202198	1/4"	3	4.04
# 2	31.4	13/16"	FBC0202280	FBB0202203	1/4"	3	4.64
# 1	28.2	13/16"	FBC0202286	FBB0202208	1/4"	4	5.23
# 0	25.4	13/16"	FBC0202292	FBB0202213	1/4"	4	5.92

DIES

BSB

British brass threads

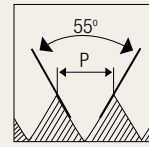

HSS

CS

BS
1127

6G

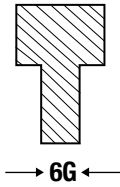
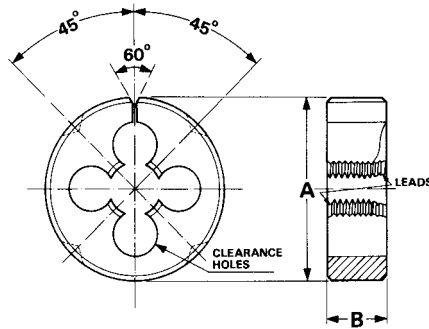

Unit : mm

Nominal Diameter ØD	TPI	Outer Diameter A	HSS	Carbon Steel	Thickness B	No. Clearance Hole	Threading Diameter
			EDP No.	EDP No.			
1/4"	26	13/16"	FBC0200371	FBB0200399	1/4"	4	6.31
1/4"	26	1"	FBC0200377	FBB0200403	3/8"	4	6.31
5/16"	26	1"	FBC0200383	FBB0200416	3/8"	4	7.89
3/8"	26	1"	FBC0200389	FBB0200425	3/8"	4	9.48
7/16"	26	1.1/2"	FBC0200395	FBB0200442	1/2"	5	11.06
1/2"	26	1.1/2"	FBC0200401	FBB0200455	1/2"	5	12.64
9/16"	26	1.1/2"	FBC0200407	FBB0200468	1/2"	5	14.23
5/8"	26	1.1/2"	FBC0200413	FBB0200476	1/2"	5	15.81
3/4"	26	1.1/2"	FBC0200419	FBB0200485	1/2"	6	18.98

ME

Model engineer threads

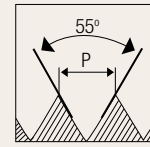

HSS

CS

BS
1127

6G

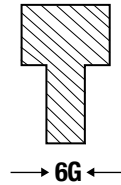
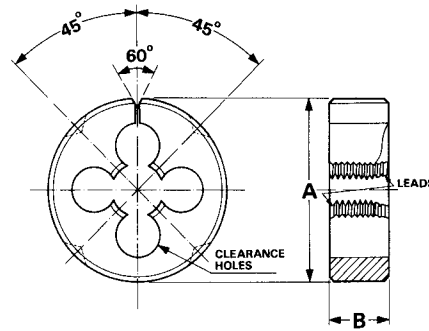

Unit : mm

Nominal Diameter	TPI	Outer Diameter	HSS	Carbon Steel	Thickness	No. Clearance Hole	Threading Diameter
ØD		A	EDP No.	EDP No.	B		
1/8"	40	13/16"	FBC0200906	FBB0200888	1/4"	3	3.14
5/32"	32	13/16"	FBC0200912	FBB0200892	1/4"	3	3.93
3/16"	40	13/16"	FBC0200918	FBB0200897	1/4"	3	4.72
7/32"	40	13/16"	FBC0200924	FBB0200902	1/4"	4	5.51
1/4"	40	13/16"	FBC0200930	FBB0200911	1/4"	4	6.31
1/4"	40	1"	FBC0202482	FBB0200916	3/8"	4	6.31
9/32"	32	1"	FBC0200936	FBB0200928	3/8"	4	7.10
5/16"	32	1"	FBC0200948	FBB0200946	3/8"	4	7.90
3/8"	32	1"	FBC0200954	FBB0200953	3/8"	4	9.48

DIES

WF

Whitworth fine special threads

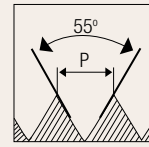

HSS

CS

BS
1127

6G

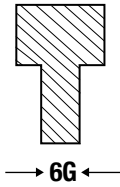
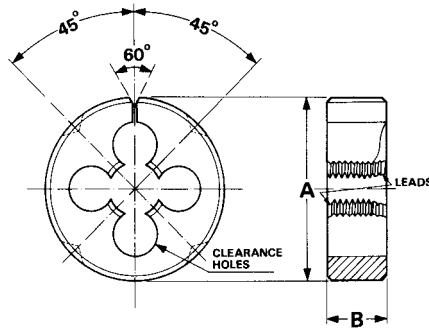

Unit : mm

Nominal Diameter ØD	TPI	Outer Diameter A	HSS	Carbon Steel	Thickness B	No. Clearance Hole	Threading Diameter
			EDP No.	EDP No.			
11/64"	40	13/16"	FBC0201032	FBB0201035	1/4"	3	4.33
3/16"	28	13/16"	FBC0201050	FBB0201045	1/4"	3	4.73
13/64"	24	13/16"	FBC0201038	FBB0201054	1/4"	3	5.13
15/64"	28	13/16"	FBC0201044	FBB0201068	1/4"	4	5.92
1/4"	32	1"	-	FBB0201083	3/8"	4	6.31
9/32"	40	1"	-	FBB0201087	3/8"	4	7.11
5/16"	40	1"	-	FBB0201091	3/8"	4	7.9
3/8"	40	1"	-	FBB0201095	3/8"	4	9.48
7/16"	40	1.1/2"	-	FBB0201107	1/2"	5	11.07
1/2"	40	1.1/2"	-	FBB0201131	1/2"	5	12.64

BSP

British standard pipe threads

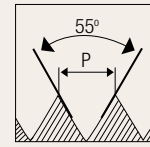

HSS

CS

BS
1127

6G

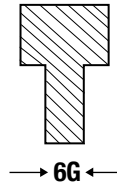
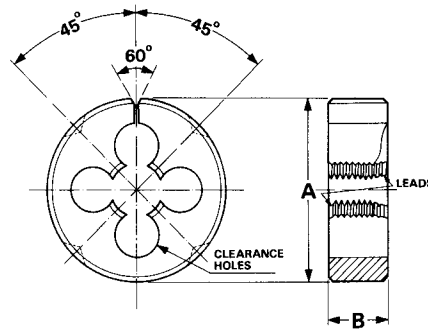

Unit : mm

Nominal Diameter ØD	TPI	Outer Diameter A	HSS	Carbon Steel	Thickness B	No. Clearance Hole	Threading Diameter
			EDP No.	EDP No.			
1/8"	28	1"	FBC0202117	FBB0202071	3/8"	4	9.68
1/4"	19	1.1/2"	FBC0202138	FBB0202088	1/2"	5	13.11
3/8"	19	1.1/2"	FBC0202149	FBB0202097	1/2"	5	16.6
1/2"	14	1.1/2"	FBC0202160	FBB0202106	1/2"	6	20.89
1/2"	14	2"	FBC0202166	FBB0202111	5/8"	5	20.89
5/8"	14	2"	FBC0202172	FBB0202116	5/8"	6	22.84
3/4"	14	2"	FBC0202178	FBB0202120	5/8"	6	26.36
7/8"	14	2"	FBC0202184	FBB0202125	5/8"	6+6	30.11
1"	11	2"	FBC0202190	FBB0202129	5/8"	6+6	33.16
1.1/8"	11	2.1/2"	FBM2300139	FBM2300426	7/8"	6	
1.1/4"	11	2.1/2"	FBM2300140	FBM2300427	7/8"	6	
1.1/4"	11	3"	FBM2300141	FBM2300428	7/8"	6	
1.3/8"	11	4"	FBM2300142	FBM2300430	1"		
1.1/2"	11	4"	FBM2300144	FBM2300431	1"	6	
1.3/4"	11	4"	FBM2300145	FBM2300432	1"		
2"	11	4"	FBM2300146	FBM2300433	1"	6	

DIES

BSPT

British standard taper pipe threads

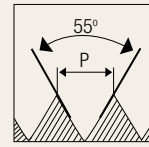

HSS **CS** **BS 1127** **6G**

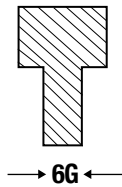
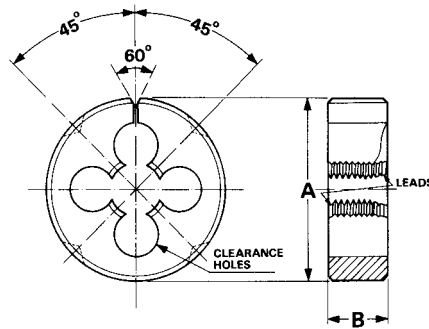

Unit : mm

Nominal Diameter ØD	TPI	Outer Diameter A	HSS	Carbon Steel	Thickness B	No. Clearance Hole	Threading Diameter
			EDP No.	EDP No.			
1/8"	28	1"	FBM2300147	FBM2300434	10	4	
1/8"	28	1.1/2"	FBM2300148	FBM2300435	10	4	
1/4"	19	1.1/2"	FBM2300149	FBM2300437	14	4	
3/8"	19	1.1/2"	FBM2300150	FBM2300439	14	5	
3/8"	19	2"	FBM2300151	FBM2300440	14	5	
1/2"	14	2"	FBM2300152	FBM2300441	19	5	
3/4"	14	2"	FBM2300153	FBM2300442	20	6	
3/4"	14	2.1/2"	FBM2300154	FBM2300443	22	6	
1"	11	2.1/2"	FBM2300156	FBM2300444	25	6	
1"	11	3"	FBM2300157	FBM2300445	25	6	
1.1/4"	11	3"	FBM2300159	FBM2300446	25	6	
1.1/2"	11	4"	FBM2300160	FBM2300447	25	6	
2"	11	4"	FBM2300161	FBM2300448	27	6	

DIES

UNC

Unified coarse threads

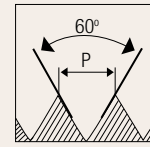

HSS

CS

BS
1127

2A

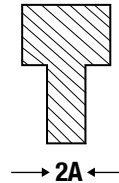
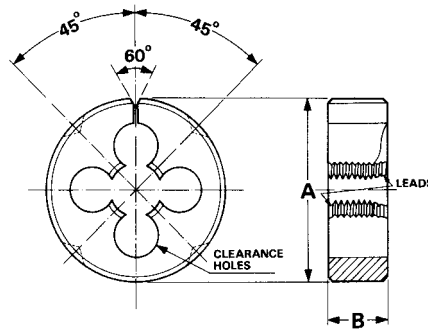

Unit : mm

Nominal Diameter	TPI	Outer Diameter	HSS	Carbon Steel	Thickness	No. Clearance Hole	Threading Diameter
ØD		A	EDP No.	EDP No.	B		
# 4	40	13/16"	FBC0200682	FBB0200706	1/4"	3	2.83
# 5	40	13/16"	FBC0200688	FBB0200714	1/4"	3	3.15
# 6	32	13/16"	FBC0200704	FBB0200722	1/4"	3	3.48
# 8	32	13/16"	FBC0200715	FBB0200730	1/4"	3	4.14
# 10	24	13/16"	FBC0200726	FBB0200738	1/4"	3	4.79
# 12	24	13/16"	FBC0200742	FBB0200750	1/4"	4	5.45
1/4"	20	13/16"	FBC0200747	FBB0200758	1/4"	4	6.31
1/4"	20	1"	FBC0200753	FBB0200766	3/8"	4	6.31
5/16"	18	1"	FBC0200769	FBB0200782	3/8"	4	7.89
3/8"	16	1"	FBC0200791	FBB0200799	3/8"	4	9.47
7/16"	14	1.1/2"	FBC0200817	FBB0200824	1/2"	4	11.05
1/2"	13	1.1/2"	FBC0200843	FBB0200840	1/2"	4	12.62
9/16"	12	1.1/2"	FBC0200859	FBB0200852	1/2"	5	14.21
5/8"	11	1.1/2"	FBC0200865	FBB0200860	1/2"	5	15.79
3/4"	10	1.1/2"	FBC0200882	FBB0200872	1/2"	6	18.96

DIES

UNC

Unified coarse threads

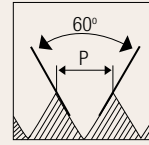

HSS

CS

BS
1127

2A

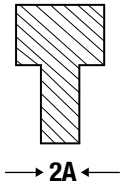
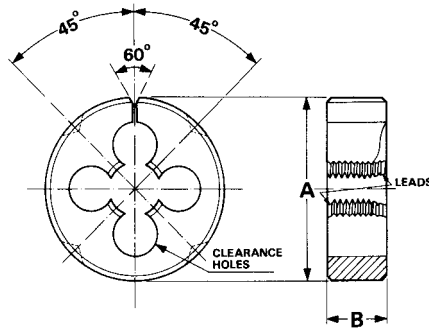

Unit : mm

Nominal Diameter ØD	TPI	Outer Diameter A	HSS	Carbon Steel	Thickness B	No. Clearance Hole	Threading Diameter
			EDP No.	EDP No.			
7/8"	9	2"	FBC0200894	FBB0200880	5/8"	5	22.14
1"	8	2"	FBC0200900	FBB0200884	5/8"	6	25.3
1.1/8"	7	2.1/4"	FBM2300048	FBM2300322	11/16"	6	
1.1/4"	7	2.1/4"	FBM2300050	FBM2300325	11/16"	6	
1.3/8"	6	2.1/2"	FBM2300054	FBM2300327	7/8"	6	
1.1/2"	6	2.1/2"	FBM2300056	FBM2300329	7/8"	6	
1.1/2"	6	3"	FBM2300057	FBM3000530	7/8"	6	
1.3/4"	5	4"	FBM2300058	FBM2300330	1"	8	
2"	4.5	4"	FBM2300059	FBM2300331	1"	6	

UNF

Unified fine threads

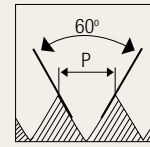

HSS

CS

BS
1127

2A

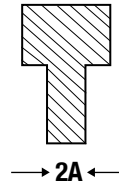
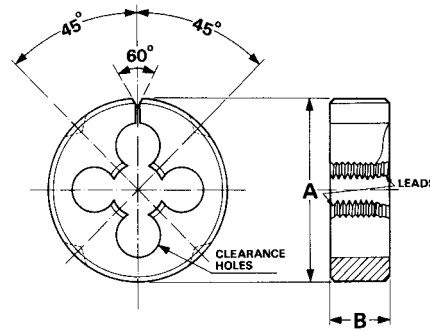

Unit : mm

Nominal Diameter ØD	TPI	Outer Diameter A	HSS	Carbon Steel	Thickness B	No. Clearance Hole	Threading Diameter
			EDP No.	EDP No.			
# 3	56	13/16"	FBC0200437	FBB0200498	1/4"	3	
# 4	48	13/16"	FBC0200443	FBB0200502	1/4"	3	2.83
# 5	44	13/16"	FBC0200449	FBB0200506	1/4"	3	3.16
# 6	40	13/16"	FBC0200465	FBB0200514	1/4"	3	3.48
# 8	36	13/16"	FBC0200476	FBB0200522	1/4"	3	4.14
# 10	32	13/16"	FBC0200487	FBB0200530	1/4"	3	4.8
# 12	28	13/16"	FBC0200498	FBB0200542	1/4"	4	5.46
1/4"	28	13/16"	FBC0200515	FBB0200550	1/4"	4	6.32
1/4"	28	1"	FBC0200527	FBB0200558	3/8"	4	6.32
5/16"	24	1"	FBC0200538	FBB0200578	3/8"	4	7.9
3/8"	24	1"	FBC0200560	FBB0200599	3/8"	4	9.48
7/16"	20	1.1/2"	FBC0200586	FBB0200627	1/2"	4	11.06
1/2"	20	1.1/2"	FBC0200607	FBB0200647	1/2"	5	12.65
9/16"	18	1.1/2"	FBC0200618	FBB0200660	1/2"	5	14.23
5/8"	18	1.1/2"	FBC0200629	FBB0200669	1/2"	5	15.82
3/4"	16	1.1/2"	FBC0200646	FBB0200682	1/2"	6	18.99

DIES

UNF

Unified fine threads

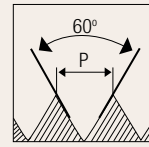

HSS

CS

BS
1127

2A

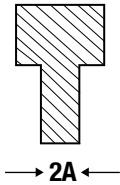
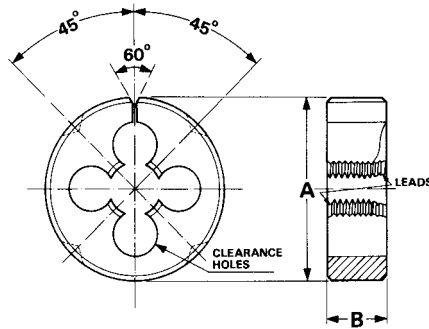

Unit : mm

Nominal Diameter	Pitch	Outer Diameter	HSS	Carbon Steel	Thickness	No. Clearance Hole	Threading Diameter
ØD	TPI	A	EDP No.	EDP No.	B		
7/8"	14	2"	FBC0200658	FBB0200690	5/8"	5	22.13
1"	12	2"	FBC0200664	FBB0200694	5/8"	6	25.31
1.1/8"	12	2.1/4"	FBM2300034	FBM2300314	11/16"	6	
1.1/4"	12	2.1/4"	FBM2300037	FBM2300317	11/16"	6	
1.3/8"	12	2.1/2"	FBM2300041	-	7/8"	6	
1.1/2"	12	2.1/2"	FBM2300043	FBM2300319	7/8"	6	
1.1/2"	12	3"	FBM2300044	FBM2300320	7/8"	6	
1.3/4"	14	4"	FBM2300046	FBM2300647	1"	6	
2"	-	4"	FBM2300047	FBM2300321	1"	6	

NPT

National taper pipe threads

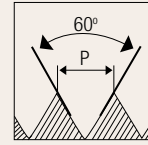

HSS

CS

BS
1127

2A

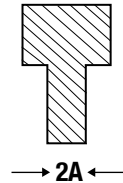
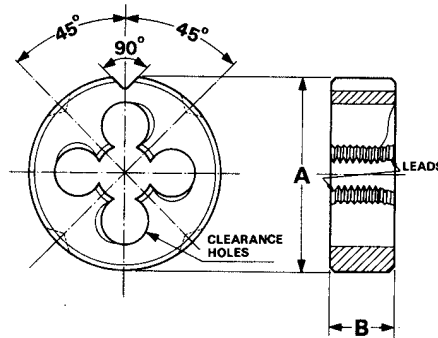

Unit : mm

Nominal Diameter ØD	TPI	Outer Diameter A	Material		Thickness B	No. Clearance Hole	Threading Diameter
			HSS EDP No.	Carbon Steel EDP No.			
1/8"	27	1"	FBM2300162	FBM2300449	10	4	
1/8"	27	1.1/2"	FBM2300163	FBM2300450	10	4	
1/4"	18	1.1/2"	FBM2300164	FBM2300453	15	4	
3/8"	18	1.1/2"	FBM2300165	FBM2300456	15	5	
3/8"	18	2"	FBM2300166	FBM2300457	14	5	
1/2"	14	2"	FBM2300167	FBM2300459	19	5	
3/4"	14	2"	FBM2300168	FBM2300461	20	6	
3/4"	14	2.1/2"	FBM2300169	FBM2300462	22	6	
1"	11.1/2	2.1/2"	FBM2300171	FBM2300464	25	6	
1"	11.1/2	3"	FBM2300172	FBM2300465	25	6	
1.1/4"	11.1/2	3"	FBM2300173	FBM2300467	25	6	
1.1/2"	11.1/2	4"	FBM2300174	FBM2300468	25	6	
2"	11.1/2	4"	FBM2300175	FBM2300469	27	6	

DIES

M

Metric coarse threads

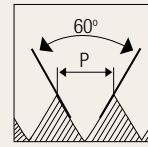

HSS

DIN 22568

6G

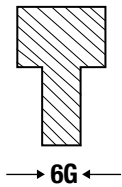
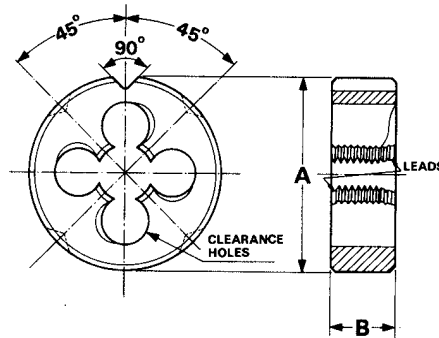

Unit : mm

Nominal Diameter	TPI	Outer Diameter	HSS	Thickness	No. Clearance Hole	Threading Diameter
ØD		A	EDP No.	B		
M3	0.5	20	FBC0202397	5	3	2.92
M3.5	0.6	20	FBC3202399	5	3	3.41
M4	0.7	20	FBC0202401	5	3	3.9
M4.5	0.75	20	FBC3202404	7	3	4.4
M5	0.8	20	FBC0202408	7	3	4.9
M6	1	20	FBC0202414	7	4	5.88
M7	1	25	FBC3202478	9	4	6.88
M8	1.25	25	FBC0202423	9	4	7.86
M9	1.25	25	FBC3202479	9	4	8.86
M10	1.5	30	FBC0202498	11	4	9.85
M11	1.5	30	FBC3202480	11	4	10.85
M12	1.75	38	FBC0202443	14	4	11.83
M14	2	38	FBC0202451	14	4	13.82
M16	2	45	FBM3200278	18	5	15.82
M18	2.5	45	FBM3200282	18	5	17.79
M20	2.5	45	FBM2300611	18	5	19.79
M22	2.5	55	FBC3202481	22	5	21.79
M24	3	55	FBM3200291	22	5	23.76

MF

Metric fine threads

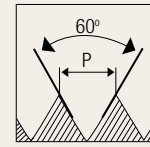

HSS DIN 22568 6G

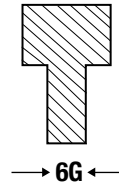
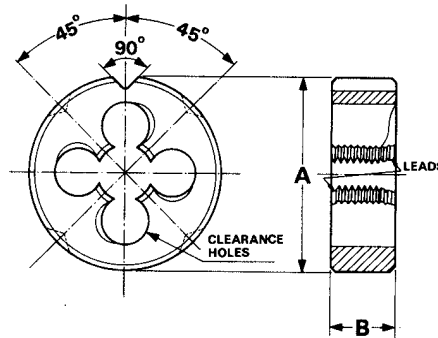

Unit : mm

DIES

Nominal Diameter	TPI	Outer Diameter	HSS		No. Clearance Hole	Threading Diameter
			EDP No.	Thickness		
ØD		A		B		
M3.5	0.6	20	FBC3202465	5	3	3.43
M4	0.5	20	FBC3202400	5	4	3.92
M4.5	0.5	20	FBC3202466	5	4	4.43
M5	0.5	20	FBC3202405	5	4	4.92
M5	0.75	20	FBC3202406	5	4	4.91
M5.5	0.75	20	FBC3202467	7	4	5.43
M6	0.5	20	FBC3202411	7	4	5.92
M6	0.75	20	FBC3202413	7	4	5.9
M7	0.75	25	FBC3202418	9	4	6.9
M8	0.5	25	FBC3202468	9	4	7.92
M8	0.75	25	FBC3202419	9	4	7.9
M8	1	25	FBC3202421	9	4	7.88
M9	0.75	25	FBC3202469	9	4	8.9
M9	1	25	FBC3202426	9	4	8.88
M10	0.75	30	FBC3202470	11	4	9.9
M10	1	30	FBC3202428	11	5	9.88
M10	1.25	30	FBC3202430	11	4	9.86
M11	0.75	30	FBC3202471	11	5	10.91
M11	1	30	FBC3202435	11	4	10.88
M12	1	38	FBC0202551	10	4	11.88
M12	1.25	38	FBC3202439	10	4	11.86
M12	1.5	38	FBC3202441	10	4	11.85
M14	1	38	FBC3202447	10	5	13.88

MF

Metric fine threads

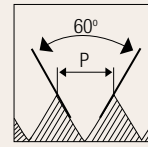

HSS

DIN 22568

6G

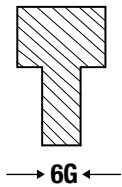
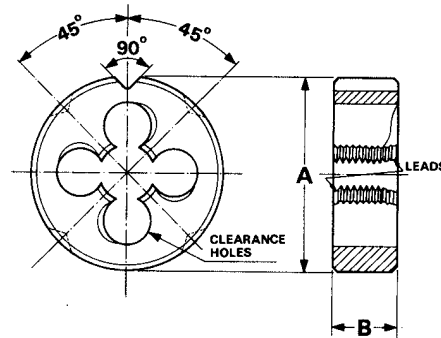

Unit : mm

Nominal Diameter	TPI	Outer Diameter	HSS	Thickness	No. Clearance Hole	Threading Diameter
ØD		A	EDP No.	B		
M14	1.5	38	FBC3202449	10	5	13.85
M15	1	38	FBC3202472	10	5	14.88
M15	1.5	38	FBC3202473	10	5	14.85
M16	1	45	FBM3200276	14	5	15.88
M16	1.5	45	FBM3200277	14	5	15.85
M17	1	45	FBC3202474	14	5	16.88
M17	1.5	45	FBC3202475	14	5	16.85
M18	1	45	FBM3200280	14	5	17.88
M18	1.5	45	FBM3200281	14	5	17.85
M18	2	45	FBC3202476	14	5	17.82
M20	1	45	FBM3200283	14	6	19.8
M20	1.5	45	FBM3200284	14	6	19.85
M20	2	45	FBM3200285	14	6	19.82
M22	1	55	FBM2400492	16	6	21.88
M22	1.5	55	FBM3200288	16	6	21.85
M22	2	55	FBC3202477	16	6	21.82
M24	1	55	FBM3200289	16	6	21.88
M24	1.5	55	FBM3200290	16	6	23.85
M24	2	55	FBM2400496	16	6	23.82
M25	1	55	FBM2400627	16	6	24.88
M25	1.5	55	FBM2400498	16	6	24.85
M25	2	55	FBM2400628	16	6	24.82
M26	1.5	55	FBM2400629	16	6	25.85

DIES

M

Metric coarse threads

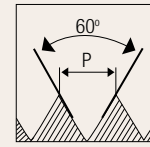

HSS
CS
BS 1127
6G

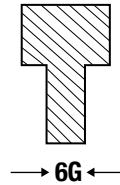
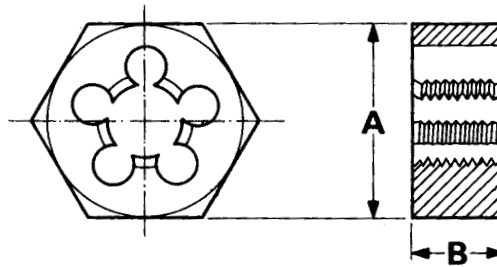

Unit : mm

Nominal Diameter	Pitch	Across Flat	HSS	Carbon Steel	Thickness
ØD	p	A	EDP No.	EDP No.	
M 2	0.4	0.710"	FBE2300078	FBD2300122	6.35
M 2.5	0.45	0.710"	FBE2300079	FBD2300123	6.35
M 3	0.5	0.710"	FBE2300080	FBD2300124	6.35
M 4	0.7	0.710"	FBE2300081	FBD2300127	6.35
M 5	0.8	0.710"	FBE2300082	FBD2300130	6.35
M 6	1	0.710"	FBE2300084	FBD2300135	6.35
M 7	1	0.710"	FBE2300085	FBD2300136	6.35
M 8	1.25	0.820"	FBE2300087	FBD2300139	7.94
M 9	1.25	0.920"	FBE2300088	FBD2300140	9.53
M 10	1.5	0.920"	FBE2300091	FBD2300144	9.53
M 12	1.75	1.100"	FBE2300096	FBD2300150	12.70
M 14	2	1.300"	FBE2300098	FBD2300154	15.88
M 16	2	1.300"	FBE2300100	FBD2300160	15.88
M 18	2.5	1.480"	FBE2300102	FBD2300163	17.46
M 20	2.5	1.480"	FBE2300104	FBD2300166	17.46
M 22	2.5	1.670"	FBE2300106	FBD2300169	20.63
M 24	3	2.050"	FBE2300108	FBD2300172	23.81
M 27	3	2.220"	FBE2300110	FBD2300176	26.99
M 30	3.5	2.220"	FBE2300112	FBD2300182	26.99
M 36	4	2.760"	FBE2300113	FBD2300191	31.75
M 39	4	2.760"	FBE2300115	FBD2300194	31.75
M 42	4.5	3.150"	FBE2300366	FBD2300198	31.75 44.45
M 45	4.5	3.150"	-	FBD2300201	31.75 44.45
M 48	5	3.150"	-	FBD2300203	31.75 44.45

DIES

MF

Metric fine threads

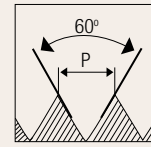

HSS

CS

BS
1127

6G

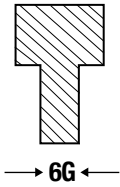
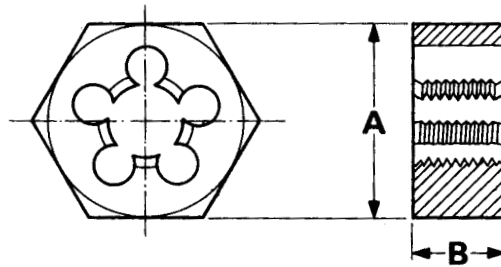

Unit : mm

Nominal Diameter	Pitch	Across Flat	HSS	Carbon Steel	Thickness
ØD	p	A	EDP No.	EDP No.	
M 3	0.6	0.710"	-	FBD2300125	6.35
M 3.5	0.6	0.710"	-	FBD2300126	6.35
M 4	0.75	0.710"	-	FBD2300128	6.35
M 5	0.5	0.710"	-	FBD2300129	6.35
M 6	0.75	0.710"	FBE2300083	FBD2300134	6.35
M 7	1	0.710"	FBE2300085	FBD2300136	6.35
M 8	1	0.820"	FBE2300086	FBD2300138	7.94
M 9	1.25	0.920"	FBE2300088	FBD2300140	9.53
M 10	1	0.920"	FBE2300089	FBD2300142	9.53
M 10	1.25	0.920"	FBE2300090	FBD2300143	9.53
M 11	1.5	1.010"	FBE2300092	FBD2300146	11.11
M 12	1	1.100"	FBE2300093	FBD2300147	12.70
M 12	1.25	1.100"	FBE2300094	FBD2300148	12.70
M 12	1.5	1.100"	FBE2300095	FBD2300149	12.70

DIES

MF

Metric fine threads

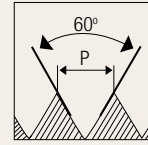

HSS

CS

BS
1127

6G

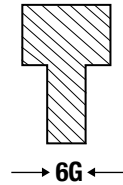
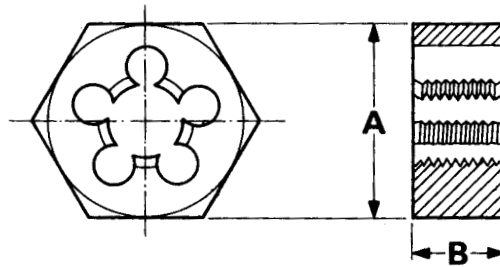

Unit : mm

Nominal Diameter	Pitch	Across Flat	HSS	Carbon Steel	Thickness
ØD	p	A	EDP No.	EDP No.	
M 14	1.25	1.300"	-	FBD2300152	15.88
M 14	1.5	1.300"	FBE2300097	FBD2300153	15.88
M 16	1.5	1.300"	FBE2300099	FBD2300158	15.88
M 18	1.5	1.480"	FBE2300101	FBD2300162	17.46
M 20	1.5	1.480"	FBE2300103	FBD2300164	17.46
M 22	1.5	1.670"	FBE2300105	FBD2300167	20.63
M 24	1.5	2.050"	FBE2300107	FBD2300170	23.81
M 25	1.5	2.220"	-	FBD2300173	26.99
M 27	1.5	2.220"	FBE2300109	FBD2300174	26.99
M 27	2	2.220"	-	FBD2300175	26.99
M 30	1.5	2.220"	FBE2300111	FBD2300179	26.99
M 30	2	2.220"	-	FBD2300180	26.99
M 30	3	2.220"	-	FBD2300181	26.99
M 32	1.5	2.220"	-	FBD2300183	26.99
M 33	3.5	2.580"	-	FBD2300187	28.58

DIES

BSW

Whitworth coarse threads

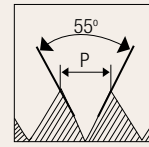

HSS
CS
BS 1127
6G

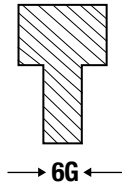
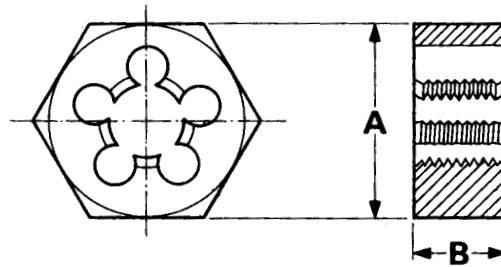

Unit : mm

Nominal Diameter	TPI	Across Flat	HSS	Carbon Steel	Thickness
ØD		A	EDP No.	EDP No.	
1/8"	40	0.710"	FBE2300001	FBD2300001	6.35
5/32"	32	0.710"	FBE2300002	FBD2300002	6.35
3/16"	24	0.710"	FBE2300003	FBD2300003	6.35
7/32"	24	0.710"	-	FBD2300004	6.35
1/4"	20	0.710"	FBE2300004	FBD2300005	6.35
9/32"	20	0.820"	-	FBD2300006	7.94
5/16"	18	0.820"	FBE2300005	FBD2300007	7.94
3/8"	16	0.920"	FBE2300006	FBD2300008	9.53
7/16"	14	1.010"	FBE2300007	FBD2300009	11.11
1/2"	12	1.100"	FBE2300008	FBD2300010	12.70
9/16"	12	1.300"	FBE2300009	FBD2300011	15.88
5/8"	11	1.300"	FBE2300010	FBD2300012	15.88
3/4"	10	1.480"	FBE2300011	FBD2300013	17.46
7/8"	9	1.670"	FBE2300012	FBD2300014	20.63
1"	8	2.050"	FBE2300013	FBD2300015	23.81
1.1/8"	7	2.220"	FBE2300014	FBD2300016	26.99
1.1/4"	7	2.220"	FBE2300015	FBD2300017	26.99
1.3/8"	6	2.580"	FBE2300016	FBD2300018	28.58
1.1/2"	6	2.760"	FBE2300017	FBD2300019	31.75
1.3/4"	6	3.150"	FBE2300018	FBD2300021	31.75 44.45
2"	4.1/2	3.550"	FBE2300019	FBD2300022	31.75 44.45

DIES

BSF

Whitworth fine threads

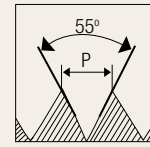

HSS

CS

BS
1127

6G

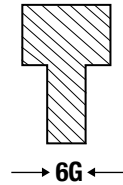
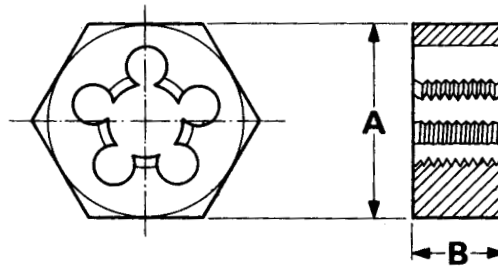

Unit : mm

Nominal Diameter	TPI	Across Flat	HSS	Carbon Steel	Thickness
ØD		A	EDP No.	EDP No.	
3/16"	32	0.710"	FBE2300022	FBD2300026	6.35
7/32"	28	0.710"	-	FBD2300027	6.35
1/4"	26	0.710"	FBE2300023	FBD2300028	6.35
5/16"	22	0.820"	FBE2300024	FBD2300029	7.94
3/8"	20	0.920"	FBE2300025	FBD2300030	9.53
7/16"	18	1.010"	FBE2300026	FBD2300031	11.11
1/2"	16	1.100"	FBE2300027	FBD2300032	12.70
9/16"	16	1.300"	FBE2300346	FBD2300033	15.88
5/8"	14	1.300"	FBE2300028	FBD2300034	15.88
3/4"	12	1.480"	FBE2300029	FBD2300035	17.46
7/8"	11	1.670"	FBE2300030	FBD2300036	20.63
1"	10	2.050"	FBE2300031	FBD2300037	23.81

DIES

BSP

British standard pipe threads

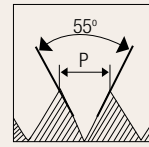

HSS

CS

BS
1127

6G

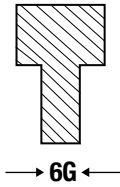
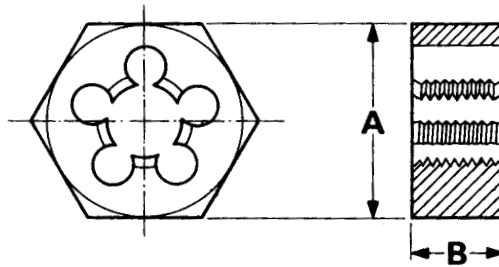

Unit : mm

Nominal Diameter ØD	TPI	Across Flat	HSS	Carbon Steel	Thickness
		A	EDP No.	EDP No.	
1/8"	28	0.920"	FBE2300067	FBD2300094	9.53
1/4"	19	1.100"	FBE2300068	FBD2300095	12.70
3/8"	19	1.300"	FBE2300069	FBD2300096	15.88
1/2"	14	1.670"	FBE2300070	FBD2300097	20.63
5/8"	14	1.670"	FBE2300071	FBD2300098	20.63
3/4"	14	2.050"	FBE2300072	FBD2300099	23.81
7/8"	14	2.220"	-	FBD2300100	26.99
1"	11	2.580"	FBE2300073	FBD2300101	28.58
1.1/4"	11	2.760"	FBE2300078	FBD2300102	31.75
1.1/2"	11	3.150"	FBE2300075	FBD2300104	31.75 44.45
2"	11	3.890"	FBE2300077	FBD2300106	31.75 44.45

BSPT

British standard taper pipe threads

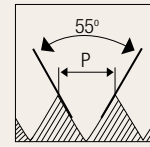

HSS

CS

BS
1127

6G

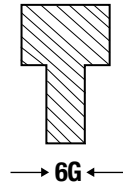
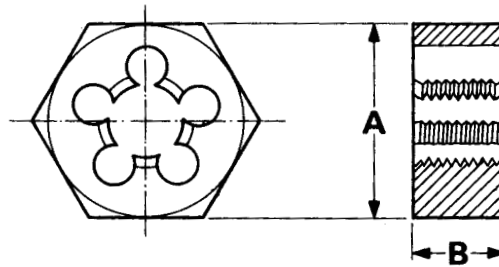

Unit : mm

Nominal Diameter ØD	TPI	Across Flat	HSS	Carbon Steel	Thickness
		A	EDP No.	EDP No.	
1/8"	28	0.920"	FBE2300367	FBD2300107	10
1/4"	19	1.100"	FBE2300368	FBD2300108	14
3/8"	19	1.300"	FBE2300369	FBD2300109	14
1/2"	14	1.670"	-	FBD2300110	19
3/4"	14	2.050"	-	FBD2300111	20
1"	11	2.580"	-	FBD2300112	25

UNC

Unified coarse threads

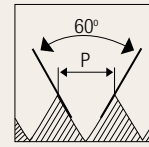

HSS

CS

BS
1127

2A

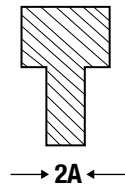
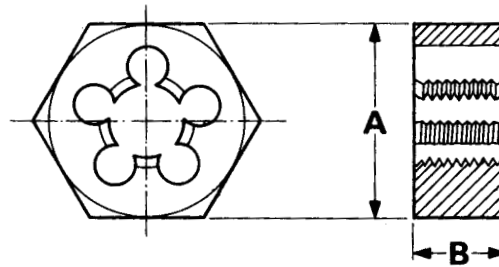

Unit : mm

Nominal Diameter ØD	TPI	Across Flat	HSS	Carbon Steel	Thickness
		A	EDP No.	EDP No.	
# 5	40	0.710"	-	FBD2300042	6.35
# 6	32	0.710"	-	FBD2300043	6.35
# 8	32	0.710"	-	FBD2300044	6.35
# 10	24	0.710"	-	FBD2300045	6.35
# 12	24	0.710"	-	FBD2300046	6.35
1/4"	20	0.710"	FBE2300033	FBD2300048	6.35
5/16"	18	0.820"	FBE2300034	FBD2300049	7.94
3/8"	16	0.920"	FBE2300035	FBD2300050	9.53
7/16"	14	1.010"	FBE2300036	FBD2300051	11.11
1/2"	13	1.100"	FBE2300037	FBD2300052	12.70
9/16"	12	1.300"	FBE2300038	FBD2300053	15.88
5/8"	11	1.300"	FBE2300039	FBD2300054	15.88
3/4"	10	1.480"	FBE2300040	FBD2300055	17.46
7/8"	9	1.670"	FBE2300041	FBD2300056	20.63
1"	8	2.050"	FBE2300042	FBD2300057	23.81
1.1/8"	7	2.220"	FBE2300043	FBD2300058	26.99
1.1/4"	7	2.220"	FBE2300044	FBD2300059	26.99
1.3/8"	6	2.580"	FBE2300045	FBD2300060	28.58
1.1/2"	6	2.760"	FBE2300046	FBD2300061	31.75

UNF

Unified fine threads

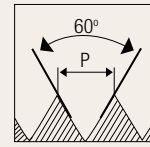

HSS

CS

BS
1127

2A

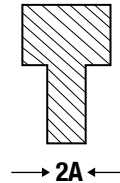
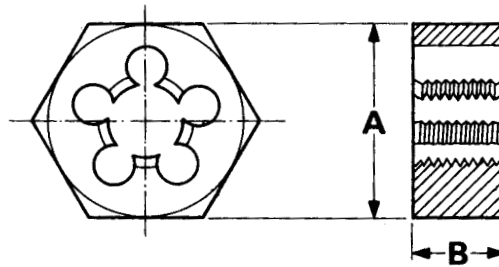

Unit : mm

Nominal Diameter ØD	TPI	Across Flat	HSS	Carbon Steel	Thickness
		A	EDP No.	EDP No.	
# 5	44	0.710"	-	FBD2300066	6.35
# 6	40	0.710"	-	FBD2300067	6.35
# 8	36	0.710"	-	FBD2300068	6.35
# 10	32	0.710"	FBE2300049	FBD2300069	6.35
# 12	28	0.710"	-	FBD2300070	6.35
1/4"	28	0.710"	FBE2300051	FBD2300072	6.35
5/16"	24	0.820"	FBE2300052	FBD2300073	7.94
3/8"	24	0.920"	FBE2300053	FBD2300074	9.53
7/16"	20	1.010"	FBE2300054	FBD2300075	11.11
1/2"	20	1.100"	FBE2300055	FBD2300076	12.70
9/16"	18	1.300"	FBE2300056	FBD2300077	15.88
5/8"	18	1.300"	FBE2300057	FBD2300078	15.88
3/4"	16	1.480"	FBE2300058	FBD2300079	17.46
7/8"	14	1.670"	FBE2300059	FBD2300080	20.63
1"	12	2.050"	FBE2300060	FBD2300081	23.81
1.1/8"	12	2.220"	FBE2300061	FBD2300082	26.99
1.1/4"	12	2.220"	FBE2300062	FBD2300083	26.99
1.3/8"	12	2.580"	FBE2300063	FBD2300084	28.58
1.1/2"	12	2.760"	FBE2300064	FBD2300085	31.75

NPT

National taper pipe threads

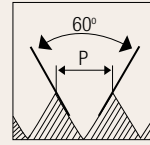

HSS

CS

BS
1127

2A

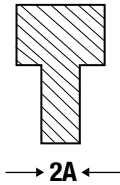
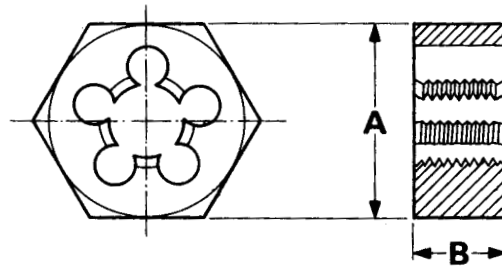

Unit : mm

Nominal Diameter	TPI	Across Flat	HSS	Carbon Steel	Thickness
ØD		A	EDP No.	EDP No.	
1/8"	27	0.920"	FBE2300370	FBD2300114	10
1/4"	18	1.100"	FBE2300371	FBD2300115	15
3/8"	18	1.300"	FBE2300372	FBD2300116	15
1/2"	14	1.670"	FBE2300373	FBD2300117	19
3/4"	14	2.050"	FBE2300374	FBD2300118	20
1"	11.1/2	2.580"	FBE2300375	FBD2300119	25
1.1/2"	11.1/2	3.150"	FBE2300376	FBD2300121	
2"	11.1/2	3.890"	FBE2300379	-	

ROUND DIES NOMENCLATURE

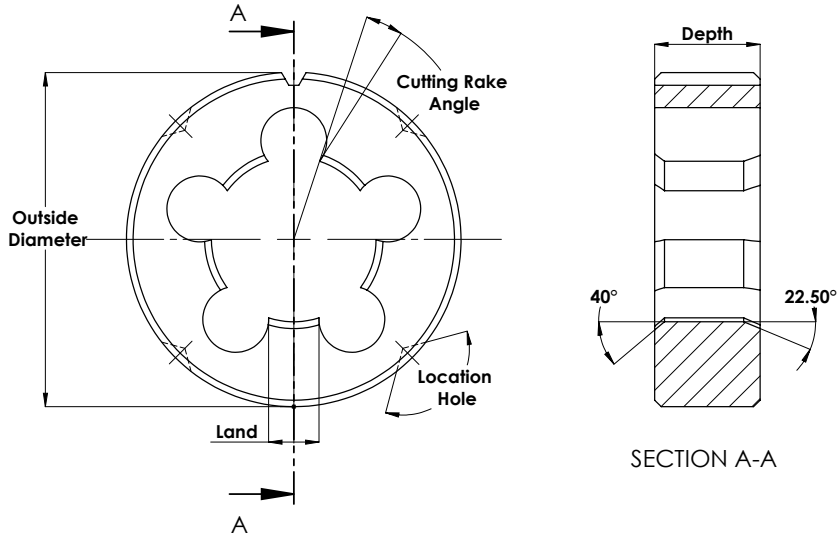

HEXAGONAL DIES NOMENCLATURE

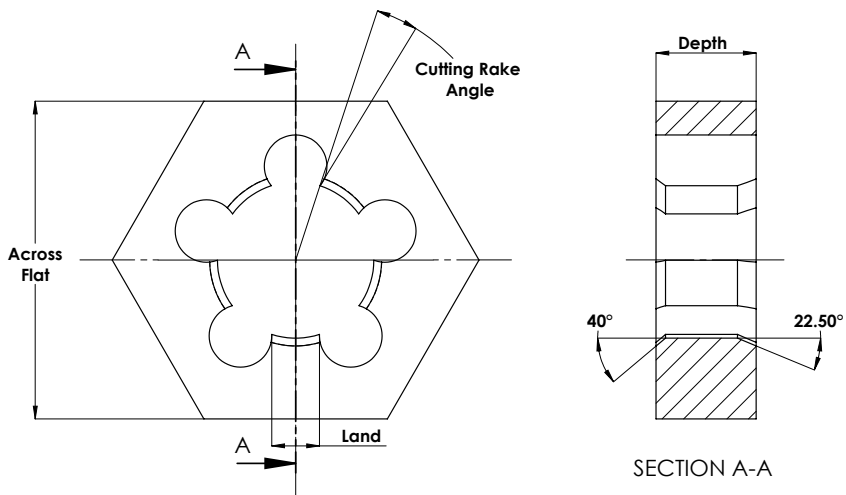

DOS AND DONT'S- THREADING WITH DIES

- **CHAMFER:** make a chamfer at the end of the bar at an angle of 45 degrees to remove sudden loading of the leading edges. This has to be done before starting the die or die nut. Also it has to be made certain that the die or die nut is presented to the bolt squarely.
- **TOLERANCE:** Major diameter of the bolt usually has large tolerances. Use this to your advantage by reducing the diameter of the bar. Thus, the cutting force will be reduced to a minimum. If tolerance class is not specified, consider tolerance applicable for medium range i.e. 6H and 6G.
- **SWarf:** To direct the swarf away from cutting area, it is always preferable to use the gun nose type of die.
- **LUBRICANT:** the cutting area should always be supplied with a steady flow of the correct lubricant. 5. Split dies: To avoid rubbing, the adjustable split die should not open out. Move the adjustable screws equally by say, 0.15 mm to close the split die. If it is done unequally, there may be pressure on one side which may lead to breakage.
- **CLEANING:** As a norm, die nuts are used for cleaning out existing threads. Usually the process is done by hand. Avoid using die nuts for thread cutting unless it is an exception.
- **RAKE ANGLE:** Large rake angle for long chip formation whereas a small rake angle for short chip formation. If applicable and or workpiece material isn't specified, assume it as intermediate tensile strength.



DIVISIONAL SALES OFFICES ADDRESS / PH. NO.

AHMEDABAD

1st floor, Pranvijay building,
Opp. Bata Showroom, Nr. Times of India, Ashram road,
Ahmedabad - 380007
Telephone: +91 (0) 79 26587769

BENGALURU

#3rd floor, Classic Building, 24 Richmond road
Bengaluru-560025
Telephone: +91 (0) 80 43230129
Fax: +91 (0) 80 43230110

CHANDIGARH

House No. 527, Sector 11B,
Chandigarh – 160002
Telephone: +91 (0) 9779177545

CHENNAI

Catholic Centre, 1st Floor,
108, Armenian Street,
Chennai - 600001
Telephone: +91 (0) 44 25389890/95,
Fax: +91 (0) 44 25360872

NEW DELHI

9-10/3, Laxman House,
Asaf Ali Road,
New Delhi - 110002
Telephone: +91 (0) 11 43000121-129
Fax: +91 (0) 11 43000130

KOLKATA

Royal insurance building,
5&7 N.S Road, Ground Floor,
Kolkata-700001
Telephone: +91 (0) 33 22622947

MUMBAI

Saki-Powai Road
Chandivali Andheri East
Mumbai- 400072
Telephone: +91 (0) 22 28471861

PUNE

4th Floor, Bhosale Heights,
Opp. Deendayal Hospital, Shivajinagar,
Pune- 411005
Telephone: +91 (0) 20 41359108

SECUNDERABAD

5th floor, P.V.S Mansion, Somasundaram Street,
Beside Manju Theatre, S.D Road,
Secunderabad-500003
Telephone: +91 (0) 40 27814585; +91 (0) 40 27844967

AURANGABAD

B-13, MIDC, Waluj,
Aurangabad - 431133
Telephone: +91 (0) 240 2553422

INTERNATIONAL SALES

Saki-Powai Road
Chandivali Andheri East
Mumbai- 400072
Telephone: +91 (0) 22 28471861



High Performance Cutting Tools



Forbes & Company Limited

Saki Powai Road, Chandivali,
Mumbai 400 072, India

Phone: +91 22 2847 1861

Email: sales@forbes.co.in

Website: www.totem-forbes.com

